

MMP160VV

MMP190VV

MMP240VV

MMP190VV
Combi

MMP 240VV
Combi

- Power: Single phase.
MMP 160VV: 220 Watts
MMP 190VV: 250 Watts
MMP 240VV: 270 Watts
- Variable speed: from 2000 to 12500 rpm
- Automatic speed self regulation system
- All stainless steel removable shaft on all three models and removable bell on MMP 190VV and MMP240VV for maximum sanitation.
- Reinforced coupling design for longer lifespan.
- Shaft length:
MMP 160 VV - 7"
MMP 190 VV - 8"
MMP 240 VV - 12"
Whisk length for Combi models: 7"
- 2 discs come standard with all models: one for cutting and one stirring.
- 1 Year "No Hassle" Replacement Warranty.
- ETL Electrical and Sanitation listed/CETL (Canada).

Mini size, Maxi Performance.
Ideal for "sauces and small quantities"



Robot Coupe U.S.A., Inc.
P.O. Box 16625
Jackson, MS 39236-6625
1-800-824-1646 • (601) 898-8411
FAX: (601) 898-9134
www.robotcoupeusa.com • e-mail: info@robotcoupeusa.

"The Inventor & World Leader in Food Processors"

Specifications

STANDARD MODEL: Variable Speed Power Mixer with stainless steel mixer attachment with removable stainless steel knife, mixer blade, splash guard, wall mount and blade disassembly tool. Combi models include 7" whisk.

ELECTRICAL REQUIREMENTS: 120V, 60HZ, single phase

SWITCHING: "On/Off control button and variable speed control.

MOTOR:

- MMP 160VV: 220 Watts
- MMP 190VV: 250 Watts
- MMP 240VV: 270 Watts

SHIPPING WEIGHT:

- MMP 160VV: 5 lbs
- MMP 190VV: 5 lbs
- MMP 240VV: 5 lbs

STANDARDS: ETL electrical & sanitation, cETL (Canada)

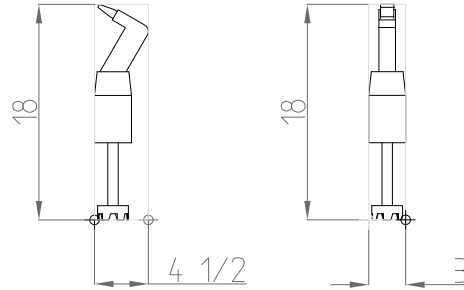

MMP160VV

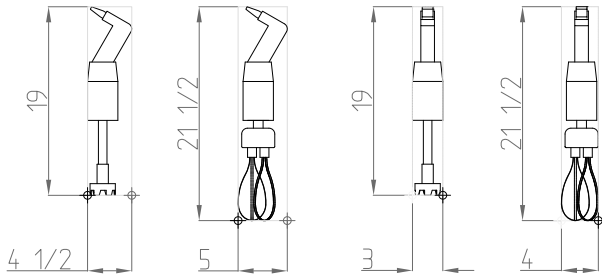
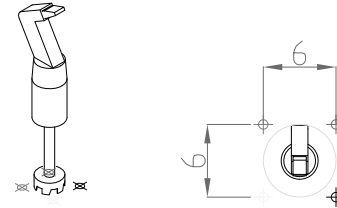

MMP190VV & MMP190VV Combi

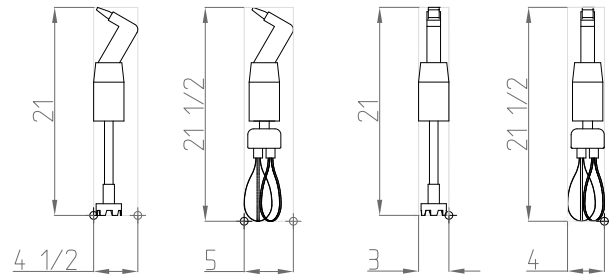

MMP240VV & MMP240VV Combi



Ref #121106

Robot Coupe U.S.A., Inc.
 P.O. Box 16625
 Jackson, MS 39236-6625
 1-800-824-1646
 (601) 898-8411
 FAX: (601) 898-9134
 www.robotcoupeusa.com
 e-mail: info@robotcoupeusa.com

Distributed by: