



**Multi-Compartment steamers & Combi-ovens**  
**P/N 1190862**



**Citryne™**

**P/N 1190862**

**This Southbend water treatment system provides the necessary technology to control chlorine, sediment and to solve scale problems. Our water treatment system is effective in all water conditions.**

**QUICK FACTS**

- Neutralizes scale**
  - Up to 99% chlorine reduction**
  - 5 micron filtration**
  - Easy cartridge change out**
  - Quick disconnect fittings**
  - 6 month cartridge life**
  - Guaranteed**
  - Efficient & affordable**
- Made in USA**

**This water treatment system meets the water quality requirements for alkalinity, pH and chlorine.**

**SPECIFICATIONS**

Maximum pressure: 80 psi non shock	Shipping weight: 23 lbs.
Maximum temperature: 100° F	Cartidge life: Up to 6 months
Dimensions: 25" H x 11" W x 5.0" D	Replacements: Stage 1 - P/N 1190865
Fittings: 1/2" NPT fittings at manifold	Stage 2 - P/N 1190866
Flow rate: Up to 3 gallons per minute	Patent Pending



# Multi-compartment steamers & Combi-ovens P/N 1190862

## SCALE CONTROL

Calcium and Magnesium are the two minerals that form scale on heating elements which results in scale build up.

Scale build up on heating elements creates an environment where consistent and effective heating becomes nearly impossible.

As scale builds up in the equipment, the equipment becomes less efficient at heating the water and the element requires more time and energy consumption to generate the needed steam.

This Southbend water treatment system provides the necessary technology to solve scale problems. Our water treatment is effective in all water scale conditions.



## CORROSION CONTROL



Southbend water treatment provides the solutions for chlorine and sediment control. No other treatment can provide chlorine control more affordably or efficiently. All TERRY filter housings come complete with easy cartridge change out and our own easy to read filter life gauge.

The carbon block cartridges are great for displacing traditional GAC (Granular Activated Carbon) and PAC (Powdered Activated Carbon) filters in applications where high chlorine reduction is needed. Our cartridges are able to compete with virtually all carbon blocks manufactured in the USA.



### Scale Master Filter 2 P/N 1190862

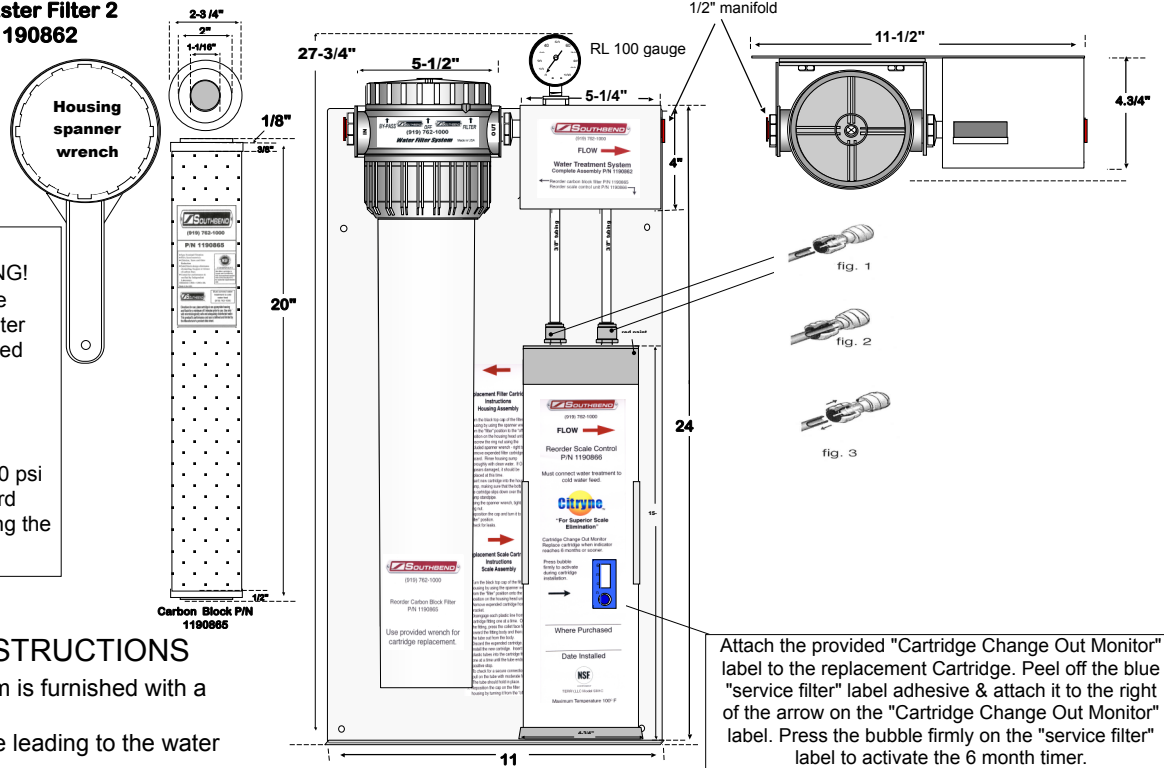

**CAUTION!**  
 READ BEFORE INSTALLING!  
 A pressure regulator **MUST** be installed before housing, if water pressure will at any time exceed the  
**MAXIMUM RATING OF 100 PSI (6.8 BAR).**  
 It is recommended that the pressure regulator be set at 80 psi (5.6 bar) or less. This will guard against the pressure exceeding the maximum rating at any time.

### INSTALLATION INSTRUCTIONS

The water treatment system is furnished with a mounting panel.

1. Turn off water supply line leading to the water treatment system.
2. Mount system on the wall **vertically**. The system **MUST** be mounted vertically to function properly. Use 1/4" mounting holes in the mounting panel.
3. Connect water supply line inlet 1/2" NPT female threaded head. **(Flush 5 gallons prior to use or until water flow is clear)**. Connect line outlet to 1/2" NPT female threaded manifold.
4. Turn on water to complete the installation. Check for leaks.

Attach the provided "Cartridge Change Out Monitor" label to the replacement Cartridge. Peel off the blue "service filter" label adhesive & attach it to the right of the arrow on the "Cartridge Change Out Monitor" label. Press the bubble firmly on the "service filter" label to activate the 6 month timer.

When to Replace Cartridges (P/N 1190862)  
 Replace cartridges every 4 to 6 months depending on the size the equipment and water usage.

### Carbon Filter Replacement Instructions. Model: P/N 1190865

1. Turn black top to By-Pass or off (By-Pass will allow water to continue to flow to the rest of the water supply line while replacing the Cartridge). Use the Wrench provided if necessary.
2. Turn the bottom blue Collar counter clockwise and slide down to bottom of the Housing.
3. Slide the Housing away from the Head.
4. Remove the spent Cartridge and insert the Replacement Cartridge.
5. Inspect the O-Ring at the top of the Housing and replace if it appears worn.
6. Slide the Housing back under the Head and lift and tighten the Collar by turning clockwise. Secure the Collar with the Wrench provided.
7. Turn the black top to the filter to resume water flow.
8. Check for leaks. If leaks exist, confirm that the bottom Collar is tightened securely to the Head.
9. If leaks persist, return the black top to By-Pass or Off. Remove the Collar, slide the Housing away from the Head and check that the O-Ring is good condition and properly seated. Re-attach the Housing to the Head as before and repeat Steps 7-9.

### Scale Cartridge Replacement Instructions. Model: P/N 1190866

1. Turn off water supply to the water system.
2. Remove expended cartridge from the bracket.
3. Disengage each plastic line from the cartridge fitting one at a time. On the fitting, press the collet face fully toward the fitting body and then pull the tube out from the fitting body.
4. Discard expended cartridge.
5. Insert plastic tubes into cartridge fitting one at a time until the tube ends hit a positive stop.
6. To check for a secure connection pull on the tube with moderate force. The tube should hold in place. Install new cartridge into the bracket.
7. Turn on water supply slowly. Check for leaks, before leaving installation.

When to Replace Cartridges (Order 1- Filter & 1- Scale)  
 Cartridges should be replaced every six months or when scale begins to form in the treated equipment.