

[L-Series]

**Reach-In Solid
Swing Door Freezer**

BASF3



WARRANTY

- 2 Years Parts and Labor, 5 Years on Compressor in USA



223 W. Rosecrans Ave. Gardena, CA. 90248 USA

Tel : 1.866.677.8500 / 310.808.0102
Fax : 310.808.0242 / 310.808.0262

BASF3 Bottom Mount Reach-In Solid Swing Door Freezer

L-Series

Product Specification

MODEL NAME	BASF3
Product Description	Freezer
Capacity(Cu.ft.)	72
Exterior Dimensions(WxDxH)	78" x 31 1/4" x 83 1/2"
Net Weight(lbs)	616
Foot	Caster 6
Door Type	3 Doors (Swing)
Door Stopper	Equipped (120°)
Shelves	12 ea
Input	AC115/208~230V / 60Hz
Amps	9.0 A
Compressor(Hp)	1.1 HP
Refrigerant	R-404a
Range of Temperature	-20~-10°F
Easy access for Service	Sliding Condensing Unit

* BLUE AIR has the right to change specifications without further notice.

- DOOR OPEN WARNING ALARM
- DURABLE USAGE DOOR GASKET
- HIGH DENSITY CELL POLYURETHANE INSULATION(CFC-FREE)
- ENERGY STAR RATED
- CONFORMS TO NSF/ANSI 7(ETL)

- **BOTTOM MOUNT COMPRESSOR**
The bottom mount compressor structure is placed in the coolest possible area to provide quick and easy service.
- **STAINLESS STEEL INTERIOR AND EXTERIOR**
The excellent quality of stainless steel minimizes dents, scratches and rust. It also maximizes and bright smooth sheen.
- **DIGITAL TOTAL MONITORING SYSTEM**
Offers an automatic door alarm system, easy temperature adjustment and a simple controlling defrost cycle.
- **FABRIC CONDENSATION KIT**
Absorbs the water from the defroster and evaporates naturally.
- **RECESSED DOOR HANDLES** - Our patented smooth and elegant door handles prevent shipping damage and handle breakage.
- **ROUNDED ELEGANT CORNERS**
- **SELF-CLOSING AND STAY DOOR OPEN**
Doors remain open at 120° and automatically-close at 96°.
- **DOOR LOCKS** - Each door is equipped with individual locks.
- **OVERSIZED REFRIGERATION SYSTEM**
- **AIR GUARD ON REAR WALL** - Enable to ensure proper air flow and cooling
- **INCANDESCENT LIGHT INTERIOR**
- **5" DIAMETER SWIVEL CASTERS WITH FRONT BRAKES**
- **ACCOMMODATES FULL SIZE BUN SHEET PANS**
- **1"ADJUSTABLE SHELVING HEIGHTS**

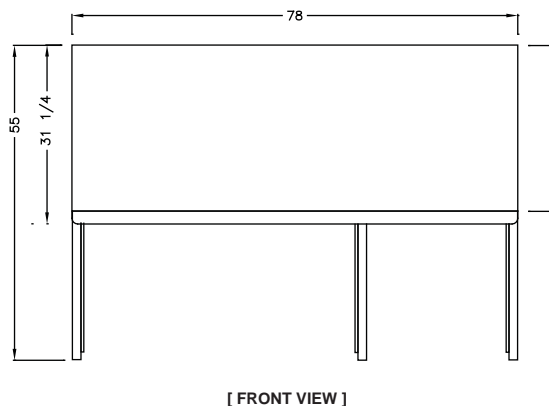
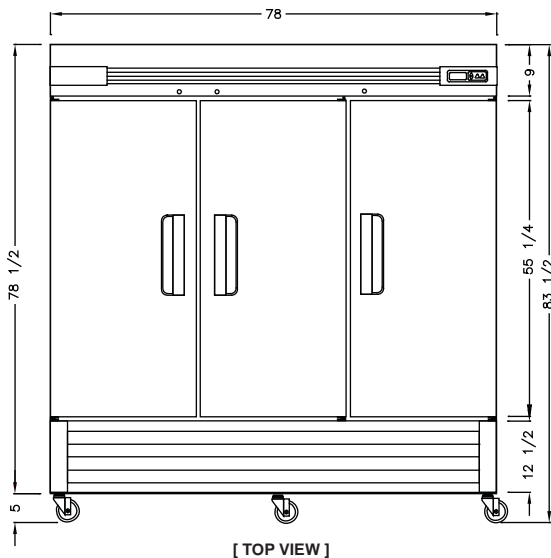

Requires
20 Amps receptacle
NEMA L14-20R



WARRANTY

- 2 Years Parts and Labor, 5 Years on Compressor in USA



BLUE AIR Commercial Refrigeration Inc.

223 W. Rosecrans Ave.
Gardena, CA. 90248 USA

Tel : 1.866.677.8500 / 310.808.0102
Fax : 310.808.0242 / 310.808.0262

<http://www.Blueairinc.com>
Email : info@blueairinc.com