



**John  
BOOS**  
Since 1887

ITEM #: \_\_\_\_\_ QTY: \_\_\_\_\_  
 MODEL #: \_\_\_\_\_  
 PROJECT NAME: \_\_\_\_\_

3601 S. Banker St. Effingham, IL 62401 • P.O. BOX 609 • Ph: (888) 431-2667 • Fax: (800) 433-2667

## DELUXE JANITOR CABINET WITH MOP SINK

### FEATURES:

- 18GA TYPE 300 STAINLESS STEEL WITH #4 POLISH SATIN FINISH
- (2) SWING DOUBLE PANEL DOORS WITH HANDLES AND MAGNETIC LATCHES
- AVAILABLE IN LEFT SIDE OR RIGHT SIDE CONFIGURATION
- INCLUDES (1) - HEAVY DUTY SERVICE FAUCET (PBF-SS-6)
- INCLUDES (1) - 10' SERVICE FAUCET HOSE (PB-HOSE-120)
- MOP SINK COMPARTMENT SIDE INCLUDES:
  - (1) OVERSIZED MOP SINK 20" X 16" X 12" WITH 3-1/2" DRAIN
  - (1) OVERHEAD STORAGE SHELF
  - (2) SIDE MOUNTED MOP/BROOM HOLDER WITH LOCKING CAM
  - PANEL-LESS BACK
- STORAGE COMPARTMENT SIDE INCLUDES:
  - (3) STORAGE SHELVES
  - BOTTOM STORAGE AREA
- VENTED SIDE PANELS

### CONSTRUCTION:

- CABINET: STAINLESS STEEL TOPS CABINETS TIG WELDED, EXPOSED WELDS ARE POLISHED TO MATCH ADJACENT SURFACE

### MATERIAL:

- CABINET: 18GA TYPE 300 STAINLESS STEEL WITH #4 POLISH, SATIN FINISH



### DELUXE JANITOR CABINET WITH MOP SINK

MODEL	QTY
PBJC-4884L	
PBJC-4884R	



PBF-SS-6



PB-HOSE-120

# DETAILED SPECIFICATIONS

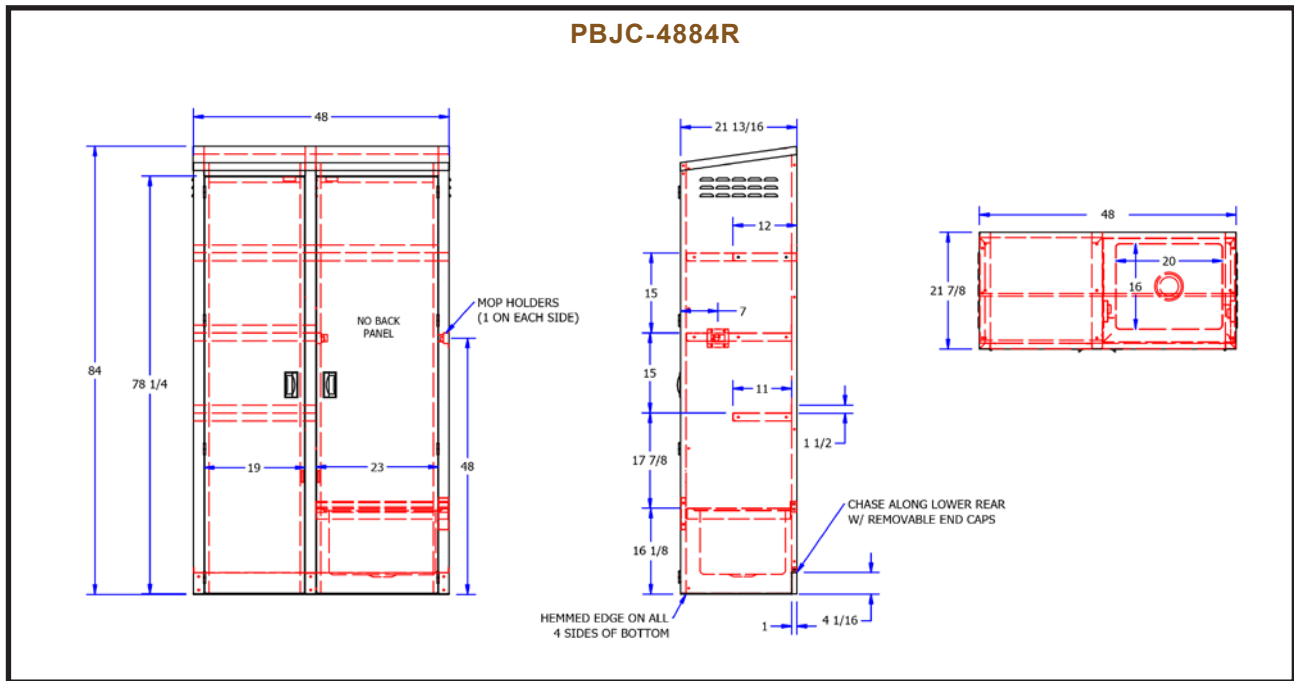
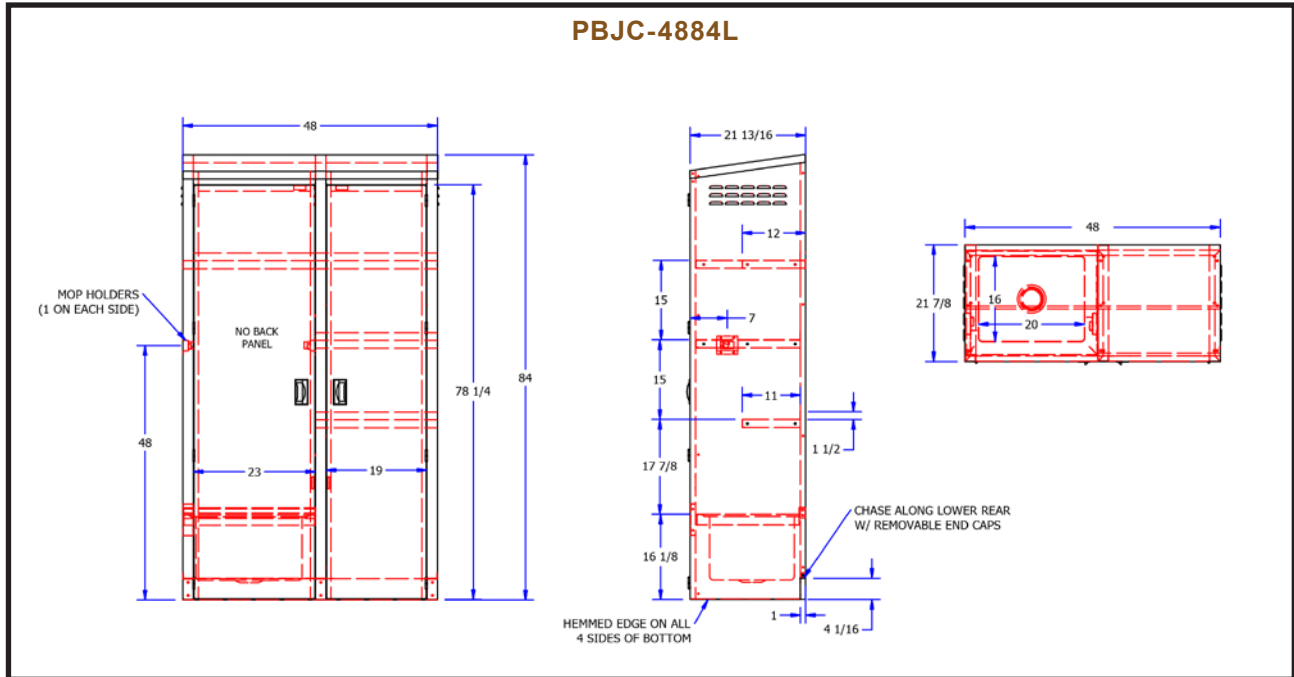

## DELUXE JANITOR CABINET WITH MOP SINK

MODEL	OVERALL SIZE (LxWxH)	MOP SINK SIZE (LxWxD)	MOP SINK LOCATION	WEIGHT (LBS)
PBJC-4884L	48" X 21-13/16" X 84"	20" X 16" X 12"	LEFT	415
PBJC-4884R	48" X 21-13/16" X 84"	20" X 16" X 12"	RIGHT	415

SOME UNITS SHIP UNASSEMBLED FOR REDUCED SHIPPING COST. ALL DIMENSIONS ARE TYPICAL. TOLERANCE +/- .500"  
 John Boos & Co. is constantly engaged in a program of improving products and therefore reserves the right to change specifications without prior notice.



3601 S. Banker St. • Effingham, IL 62401 • PO BOX 609 • quotes@johnboos.com



[www.johnboos.com](http://www.johnboos.com)