

COLD FOOD HOLDERS SQUEEZE BOTTLE HOLDERS

Models SBH-1, SBH-2, SBH-3 & SBH-8



SBH-2 86829



SBH-8 86974

BID DESCRIPTION

Squeeze Bottle Holders are designed for use in a cold table. Single (1), double (2) and triple (3) bottle holders fit in the same space as a 1/6-size steam table pan. The octuple (8) bottle holder drops in the space of a 1/3-size pan.

Squeeze bottle holders are constructed of stainless steel. A bottle cutout in the lid keeps the cold in and the open frame design below allows cold air to circulate freely, for more efficient cooling. Each unit comes complete with the appropriate number of 16 ounce (.47 L) squeeze bottles.

STANDARD FEATURES

- Stainless steel construction for long life
- Fits in the space of a standard 1/6-size steam table pan; except SBH-8 which fits in the space of a 1/3-size pan
- Lid holds bottles upright and helps keep cold table refrigeration from escaping
- Includes 16 oz (.47 L) plastic squeeze bottle(s)

ACCESSORY ITEMS

- Squeeze Bottle, 16 ounce (.47 L) 86818



2 YEAR
WARRANTY

TWO YEAR WARRANTY

Server Products equipment is backed by a two-year limited warranty against defects in materials and workmanship. For a copy of our complete warranty statement, please refer to server-products.com.

COLD FOOD HOLDERS SQUEEZE BOTTLE HOLDERS

Models SBH-1, SBH-2, SBH-3 & SBH-8

SQUEEZE BOTTLE HOLDERS SBH-1, SBH-2 & SBH-3

SBH-1 86828

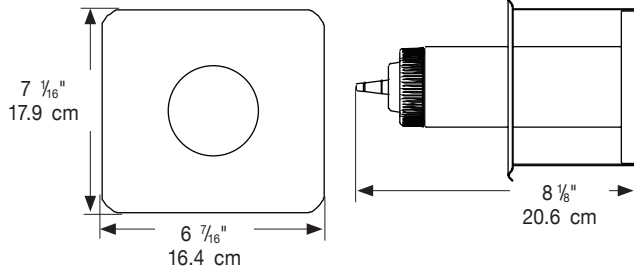

SBH-2 86829

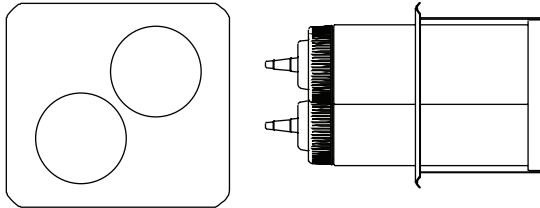

SBH-3 86831

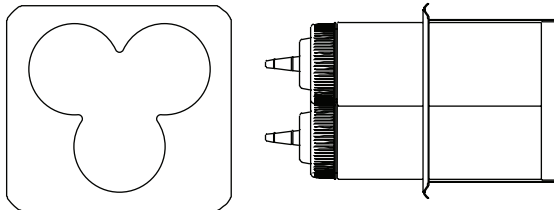

SBH-8 86974

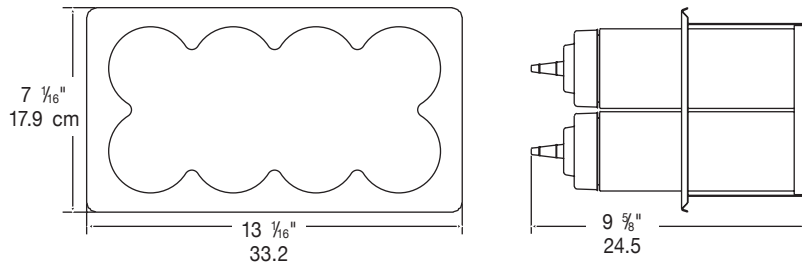

MODELS	SBH-1, SBH-2 & SBH-3	SBH-8
Capacity	16 oz (.47 L) squeeze bottle(s)	(8) 16 oz (.47 L) squeeze bottles
Height	9 5/8" 24.5 cm	9 5/8" 24.5 cm
Width	6 7/16" 16.4 cm	13 1/16" 33.2 cm
Depth	7 1/16" 17.9 cm	7 1/16" 17.9 cm
Weight	2 lb .9 kg	4 lb 1.8 kg

FOB RICHFIELD, WISCONSIN 53076