

|                  |          |                   |
|------------------|----------|-------------------|
| Project          | Quantity | Item #            |
| Model Specified: |          | CSI Section 11400 |

### Compact Undercounter Freezer Models/Self-Contained



Model ULT27-R

### 27", 32", 48", 60" & 72" Wide Models



Stainless Exterior

|  |          |
|--|----------|
| 27" One Door Freezer Hinged Left       | ULT27-L  |
| 27" One Door Freezer Hinged Right      | ULT27-R  |
| 32" One Door Freezer Hinged Left       | ULT32-L  |
| 32" One Door Freezer Hinged Right      | ULT32-R  |
| 48" Two Door Freezer Hinged Left/Right | ULT48-LR |
| 60" Two Door Freezer Hinged Left/Right | ULT60-LR |
| 72" Two Door Freezer Hinged Left/Right | ULT72-LR |

Traulsen's durable, high performance, compact undercounter freezer models provide a high quality/high value alternative to the all too common commodity types in today's market.

Durable, built with stainless steel exteriors and anodized aluminum interiors, their heavy duty cabinet construction promises years of useful service. Truly front breathing, their design allows for "zero-clearance" installation. As a result they can be placed right up against the back wall and alongside other kitchen equipment, saving valuable floor space.

Additionally, they offer a wide range of optional accessories to choose from, and are ideal for use with many different type applications.

### Standard Product Features

- Stainless Steel Exterior Top, Sides & Doors
- Anodized Aluminum Interior
- Front Breathing Self-Contained Refrigeration System
- Environmentally Friendly R-404A Refrigerant
- Self-Closing Stainless Steel Doors With Stay Open Feature At 105 Degrees
- Anodized Aluminum Interior Door Liner
- Interior Mounted Thermometer
- Two (2) Powder Coated Shelves Per Door, Mounted On Pilasters
- Automatic Non-Electric Condensate Evaporator
- Magnetic Snap-In EZ-Clean Door Gasket(s)
- 8' Cord & Plug Attached
- Set of Four (4) 4" Casters (6 For 60" & 72" models)
- Three Year Parts And Labor Warranty
- Five Year Compressor Warranty

### Optional Accessory Kits\*

- **CASTER 5SET4** (four 6" high casters for 27", 32" & 48" models)
- **CASTER 5SET6** (six 6" high casters for 60" & 72" model)
- **CASTER SET3IN** (four 3-1/2" high casters for 27", 32" & 48" models)
- **CASTER SET4** (six 3-1/2" high casters for 60" & 72" model)
- **CASTER SET2IN** (four 2-1/2" high casters for 27" & 32" models)
- **CASTER 2SET4** (four 2-3/4" high casters for 48" models)
- **CASTER 2SET6** (six 2-3/4" high casters for 60" & 72" models)
- **SHELF CPW1** (additional shelf for all 27" models)
- **SHELF CPW2** (additional shelf for all 32" models)
- **SHELF48 UPPER** (upper shelf for all 48" models)
- **SHELF48 LOWER** (lower shelf for all 48" models)
- **SHELF60 UPPER** (upper shelf for all 60" models)
- **SHELF60 LOWER** (lower shelf for all 60" models)
- **SHELF72 UPPER** (upper shelf for all 72" models)
- **SHELF72 LOWER** (lower shelf for all 72" models)
- **CU27TOP BSWO** (22 ga. stainless steel top with 4" backsplash ULT27)
- **CU32TOP BSWO** (22 ga. stainless steel top with 4" backsplash ULT32)
- **CU48TOP BSWO** (22 ga. stainless steel top with 4" backsplash ULT48)
- **CU60TOP BSWO** (22 ga. stainless steel top with 4" backsplash ULT60)
- **CU72TOP BSWO** (22 ga. stainless steel top with 4" backsplash ULT72)

\*Optional accessory kits shipped separately for field installation.

### Factory Installed Options

- Stainless Steel Finished Back
- Other Door Hinges



*This unit is listed to UL 471, CSA 120 and NSF 7 by an approved NRTL. Consult the factory or unit data plate for approval information.*



Approval: \_\_\_\_\_



**TRAULSEN**  
 4401 BLUE MOUND RD.  
 PHONE 1 (800) 825-8220  
 Website: www.traulsen.com

**FT. WORTH, TX 76106**  
 FAX-MKTG. 1 (817) 624-4302

|                  |          |                   |
|------------------|----------|-------------------|
| Project          | Quantity | Item #            |
| Model Specified: |          | CSI Section 11400 |

## Specifications

### Construction, Hardware and Insulation

Cabinet exterior front, one piece sides, and doors are constructed of 22 gauge stainless steel. Cabinet interior and door liners are constructed of anodized aluminum. The exterior cabinet back and bottom are constructed of galvanized steel.

Door self close at less than 90 degrees and also include a stay open feature at 105 degrees. Gasket profile and Santoprene® material simplify cleaning and increase overall gasket life. Both the cabinet and door(s) are insulated with an average of 2" thick high density, non-CFC, foamed in place polyurethane.

### Refrigeration System

A balanced, rear mounted, front breathing, self-contained refrigeration system using R-404A refrigerant is provided. It features a TXV valve, air-cooled hermetic compressor, a forced air evaporator coil and a non-electric condensate evaporator. An 8' cord and plug is provided. Standard operating temperature for freezer models is 0 to -5°F.

### Interior

Standard interior arrangements include two (2) powder coated wire shelves per door, mounted on pilasters. These are adjustable in 1/2" increments, allowing for a minimum of 1-1/2" spacing between shelves.

### Warranties

Both a three year parts and labor warranty and a five year compressor warranty (self-contained models only) are provided standard.

| Cabinet Dimensional Data |                 |                 |              |                       |                    |            |              |                          |
|--------------------------|-----------------|-----------------|--------------|-----------------------|--------------------|------------|--------------|--------------------------|
| Model                    | Storage cu. ft. | Width - cabinet | Width - door | Depth - door open 90° | Clear door opening | # of doors | # of shelves | Total shelf area sq. ft. |
| ULT27                    | 7.1             | 27"             | 25 7/8"      | 55 3/8"               | 22 3/4"            | 1          | 2            | 4.88                     |
| ULT32                    | 8.3             | 32"             | 30 13/16"    | 60 3/8"               | 27 3/4"            | 1          | 2            | 6.1                      |
| ULT48                    | 13.5            | 48"             | 21 1/8"      | 50 5/8"               | 18"                | 2          | 4            | 10.3                     |
| ULT60                    | 17.4            | 60"             | 25 7/8"      | 55 3/8"               | 22 3/4"            | 2          | 4            | 13.2                     |
| ULT72                    | 21.3            | 72"             | 30 13/16"    | 60 3/8"               | 27 3/4"            | 2          | 4            | 15.5                     |

| Electrical & Refrigeration Data |                |             | Shipping Data  |                         |                   |
|---------------------------------|----------------|-------------|----------------|-------------------------|-------------------|
| Model                           | Full Load Amps | BTU/HR - HP | Width - crated | Volume - crated cu. ft. | Weight - lbs.     |
| ULT27                           | 7.5            | 1740 (1/2)  | 45"            | 45                      | 240 net/275 gross |
| ULT32                           | 7.5            | 1740 (1/2)  | 45"            | 45                      | 255 net/300 gross |
| ULT48                           | 7.5            | 1740 (1/2)  | 69"            | 69                      | 355 net/400 gross |
| ULT60                           | 7.5            | 1740 (1/2)  | 69"            | 69                      | 457 net/500 gross |
| ULT72                           | 7.5            | 1740 (1/2)  | 84"            | 84                      | 548 net/575 gross |

### NOTES:

- Based on a 90 degree F ambient and 20 degree F evaporator.
- When ordering please specify: voltage, Hinging, Optional Accessories and any additional warranties.
- This unit may be manufactured in other electrical characteristics and may have additional regulatory agency approvals. Consult factory for other electrical characteristics and agency approvals based on specific electrical and country requirements. (For exact electrical information and approval marks, always refer to the data label of the unit.)
- Continued product development may necessitate specification changes without notice.

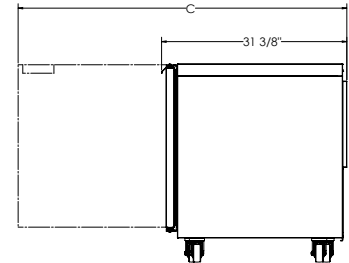
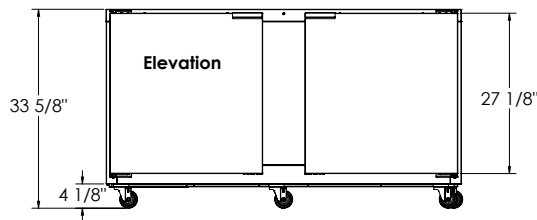
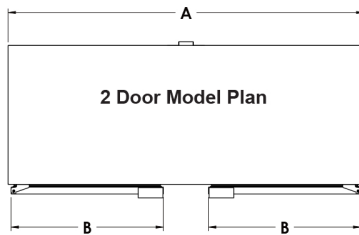
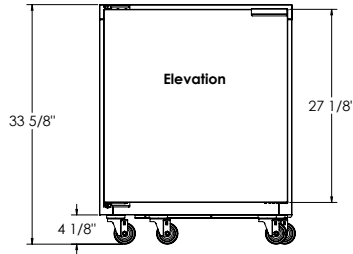
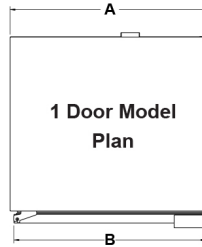

Part No. TR35925 (REV. 02-05-16)

TRAUlsen  
4401 BLUE MOUND RD.  
PHONE 1 (800) 825-8220  
Website: www.traulsen.com

FT. WORTH, TX 76106  
FAX-MKTG. 1 (817) 624-4302

