



ADA Compliant

This Space for Architect/Engineer Approval

Job Name _____ Date _____

Model Specified _____ Quantity _____

Customer/Wholesaler _____

Contractor _____

Architect/Engineer _____

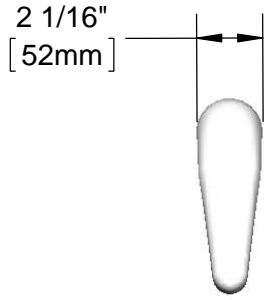

3 5/8" x 4 3/16" x 2" Deep
[92mm x 106mm x 51mm]
Water Resistant Control Module Box (White)
AC or DC Operated w/ (4) AA Batteries

Polish Chrome Plated Solid
Cast Brass Spout w/ 2.2
GPM [8.3 LPM] Vandal
Resistant Aerator & Key

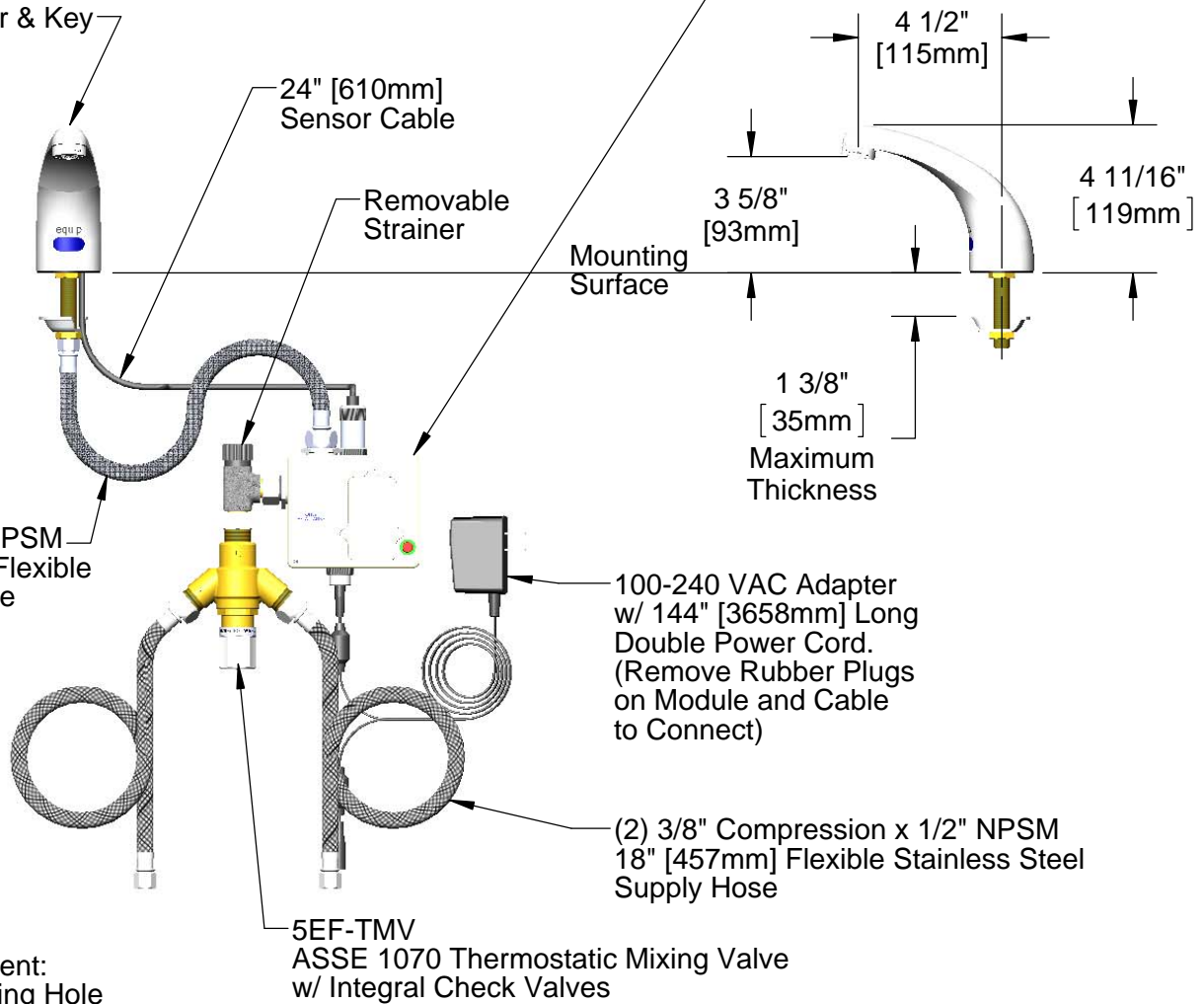

1/2" NPSM x 1/4" NPSM
18" [457mm] Long Flexible
Stainless Steel Hose

100-240 VAC Adapter
w/ 144" [3658mm] Long
Double Power Cord.
(Remove Rubber Plugs
on Module and Cable
to Connect)

(2) 3/8" Compression x 1/2" NPSM
18" [457mm] Flexible Stainless Steel
Supply Hose

Rough-In Requirement:
Ø 1" [25mm] Mounting Hole

Model Number 5EF-1D-DS-TMV	Date 08/01/12	Scale 1:6	Drawn GEF	Checked DMH	Approved JHB
-------------------------------	------------------	--------------	--------------	----------------	-----------------

Product Specifications:

**Electronic Faucet: Deck Mount, Cast Spout w/ VR 2.2 GPM
Aerator, Thermostatic Temperature Control Mixing Valve w/ Integral Check
Valves, (2) 18" Long Flexible Supply Hoses & AC-DC Control Module**



equip Foodservice Accessories
2 Saddleback Cove, P.O. Box 1088
Travelers Rest, South Carolina 29690
Phone: 800.891.4808 Fax: 800.868.0084

ITEM NO.	SALES NO.	DESCRIPTION
1	015425-45	Vandal Resistant Key
2	B-0199-09	Vandal Resistant Aerator, 2.2 GPM
3	5EF-0004	24" Sensor Cable
4	016297-45	Inlet Hose, Faucet, 1/2" NPSM-F x 1/4" NPSM-F
5	5EF-0001	equip Sensor Faucet - Control Module
6	5EF-0002	Equip AC Transformer, 100-240 VAC
7	5EF-0005	Supply Hose, 9/16-24 Female x 1/2" NPSM
8	5EF-TMV	ASSE 1070 Thermostatic Mixing Valve
9	5EF-FILTER	Replacement Filter

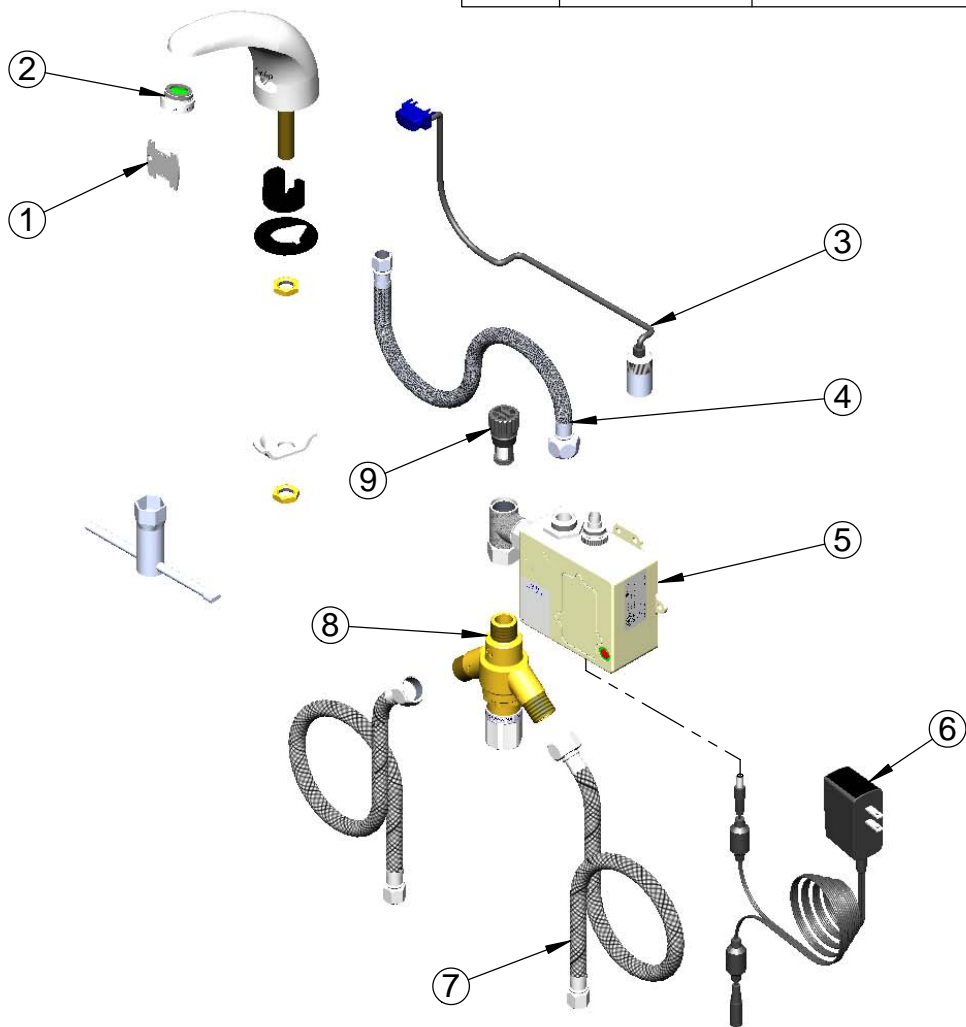

Model Number 5EF-1D-DS-TMV	Date 08/01/12	Scale NTS	Drawn GEF	Checked DMH	Approved JHB
-------------------------------	------------------	--------------	--------------	----------------	-----------------



Product Specifications:

**Electronic Faucet: Deck Mount, Cast Spout w/ VR 2.2 GPM
Aerator, Thermostatic Temperature Control Mixing Valve w/ Integral Check
Valves, (2) 18" Long Flexible Supply Hoses & AC-DC Control Module**

equip Foodservice Accessories
2 Saddleback Cove, P.O. Box 1088
Travelers Rest, South Carolina 29690
Phone: 800.891.4808 Fax: 800.868.0084