



## USCF-48

### DOUBLE DOOR STAINLESS STEEL UNDERCOUNTER FREEZER



48" DOUBLE DOOR UNDERCOUNTER FREEZER  
FEATURES:

- Durable stainless steel doors
- Stainless steel interior and exterior
- Fully balanced self contained refrigeration system
- Easy grab recessed door handles
- High density CFC free polyurethane insulation
- Spring loaded self-closing doors
- Installed 9 ft power cord comes standard
- Environmentally friendly R-404a refrigerant
- Components optimized for smooth quiet operation
- Oversized compressor and coil section
- Heavy duty castors with two front brakes
- Height adjustable shelving for easy storage solutions

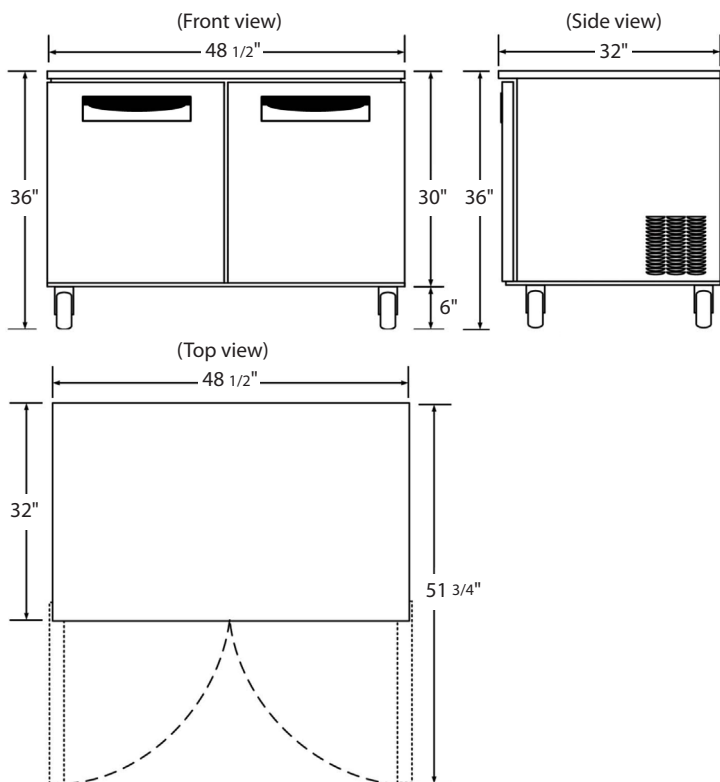

#### SPECIFICATIONS: USCF-48

Doors	2 Stainless steel swing doors
Capacity cu. ft.	12 Cu. Ft.
Shelves	4 Epoxy coated wire shelves
Compressor	1/2 HP
Dimensions	48.5"W x 32"D x 36"H
Net Weight	282 lbs
Amps	8.9 A
Power	115V / 60Hz
Power Cord	9 Ft.
Temperature	Below 0 Degrees F

\* In the pursuit of a better product, durability and performance. SATURN reserves the right to change specifications, materials and design without further notice.



WARRANTY:  
1 year parts and labor.  
5 year compressor.