

ADA Compliant

This Space for Architect/Engineer Approval

Job Name _____ Date _____
 Model Specified _____ Quantity _____
 Customer/Wholesaler _____
 Contractor _____
 Architect/Engineer _____

Rigid Gooseneck w/
2.2 GPM [8.3 LPM]
Vandal Resistant Aerator
& Key (Optional 0.5 Gpm
[1.9 LPM] VR Spray Device
Included)

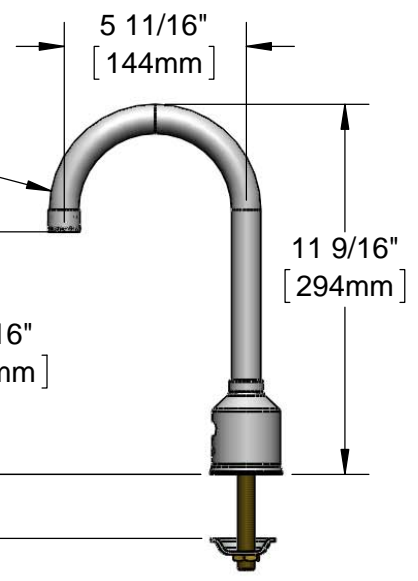

3 5/8" x 4 3/16" x 2"
[92mm x 106mm x 51mm]
Water Resistant Control
Module Box (White) w/
AC or DC Operated w/
(4) AA Batteries

Mounting Surface

2"
[51mm]
Maximum
Thickness

24" [610mm]
Sensor Cable

Removable
Strainer

1/2" NPSM x 1/4" NPSM
18" [457mm] Long
Flexible Stainless
Steel Hose

100-240 VAC Adapter
w/ 144" [3658mm] Long
Double Power Cord.
(Remove Rubber Plugs
on Module and Cable
to Connect)

Mechanical Mixing Valve
w/ Integral Check Valves

(2) 3/8" Compression x 1/2" NPSM
18" [457mm] Flexible Stainless Steel
Supply Hoses

Rough-In Requirement:
Ø 1" [25mm] Mounting Hole

Model Number 5EF-1D-DG-VF05	Date 08/29/12	Scale 1:6	Drawn KJG	Checked GEF	Approved JHB
--------------------------------	------------------	--------------	--------------	----------------	-----------------



Product Specifications:
Electronic Faucet: Deck Mount, Rigid Gooseneck w/ 0.5 GPM VR Spray Device, AC-DC Control Module, Temperature Control Mixing Valve w/ Integral Check Valves & 18" Long Flexible Supply Hoses

equip Foodservice Accessories
 2 Saddleback Cove, P.O. Box 1088
 Travelers Rest, South Carolina 29690
 Phone: 800.891.4808 Fax: 800.868.0084

ITEM NO.	SALES NO.	DESCRIPTION
1	015425-45	Vandal Resistant Key
2	B-0199-06	VR Aerator w/ Key
3	5EF-0004	24" Sensor Cable
4	016297-45	Inlet Hose, Faucet, 1/2" NPSM-F x 1/4" NPSM-F
5	5EF-0001	equip Sensor Faucet - Control Module
6	B-0199-06-N05	VR 0.5 GPM Spray Device, 55/64-27UN Female
7	5EF-0002	equip AC Transformer, 100-240 VAC
8	5EF-0005	Supply Hose, 9/16-24 Female x 1/2" NPSM
9	5EF-0006	Mechanical Mixing Valve
10	5EF-FILTER	Replacement Filter

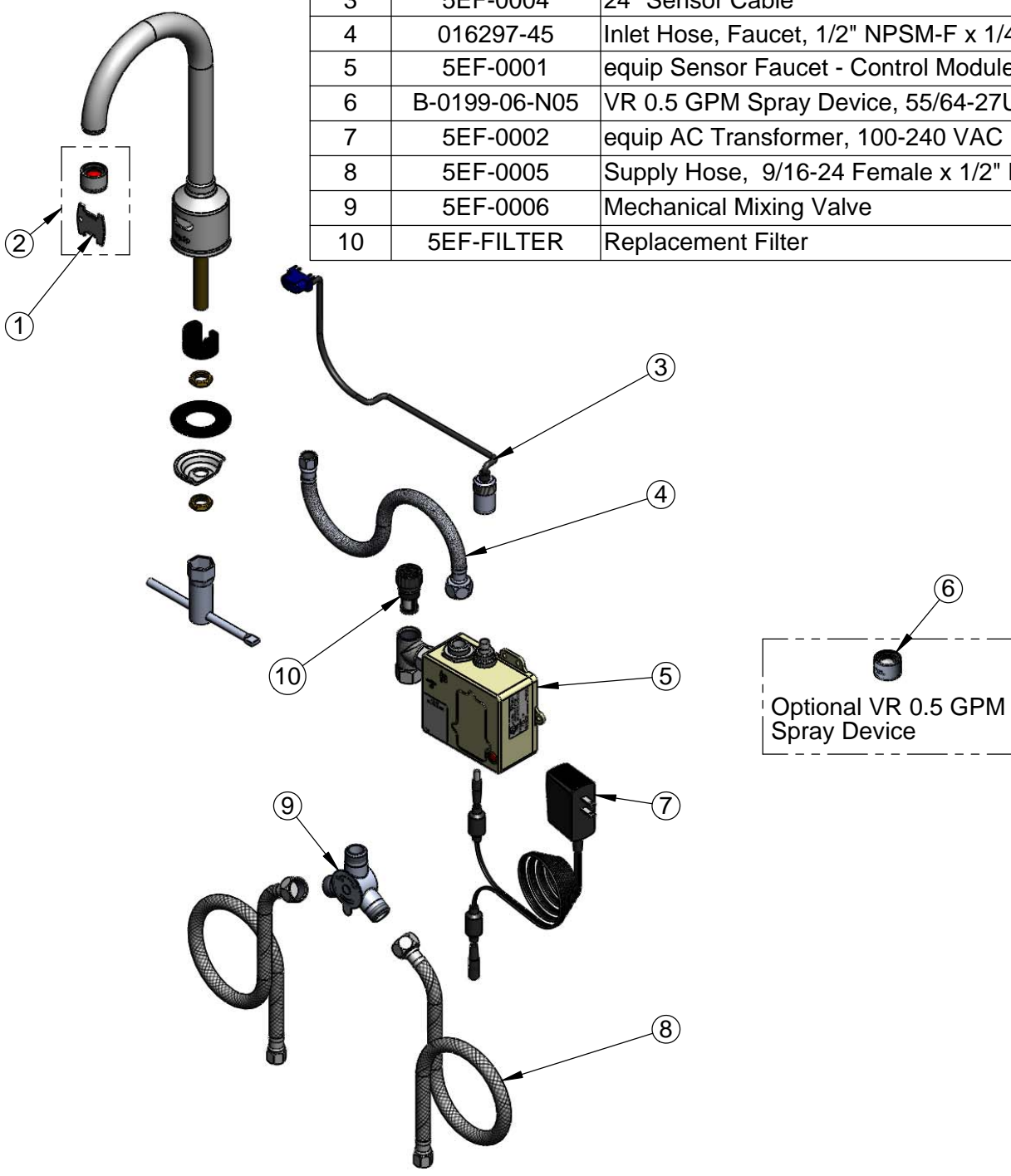

Model Number 5EF-1D-DG-VF05	Date 08/29/12	Scale NTS	Drawn KJG	Checked GEF	Approved JHB
--------------------------------	------------------	--------------	--------------	----------------	-----------------



Product Specifications:
Electronic Faucet: Deck Mount, Rigid Gooseneck w/ 0.5 GPM VR Spray Device, AC-DC Control Module, Temperature Control Mixing Valve w/ Integral Check Valves & 18" Long Flexible Supply Hoses

equip Foodservice Accessories
 2 Saddleback Cove, P.O. Box 1088
 Travelers Rest, South Carolina 29690
 Phone: 800.891.4808 Fax: 800.868.0084