

ADA Compliant

This Space for Architect/Engineer Approval

Job Name _____ Date _____

Model Specified _____ Quantity _____

Customer/Wholesaler _____

Contractor _____

Architect/Engineer _____

Polished Chrome Plated
Cast Spout w/ 2.2 GPM VR
Aerator w/ Key (Optional
0.5 GPM [1.9 LPM] VR Spray
Device Included)

3 5/8" x 4 3/16" x 2" Deep
[92mm x 106mm x 51mm]
Water Resistant Control Module
Box (White), AC or DC Operated
w/ (4) AA Batteries

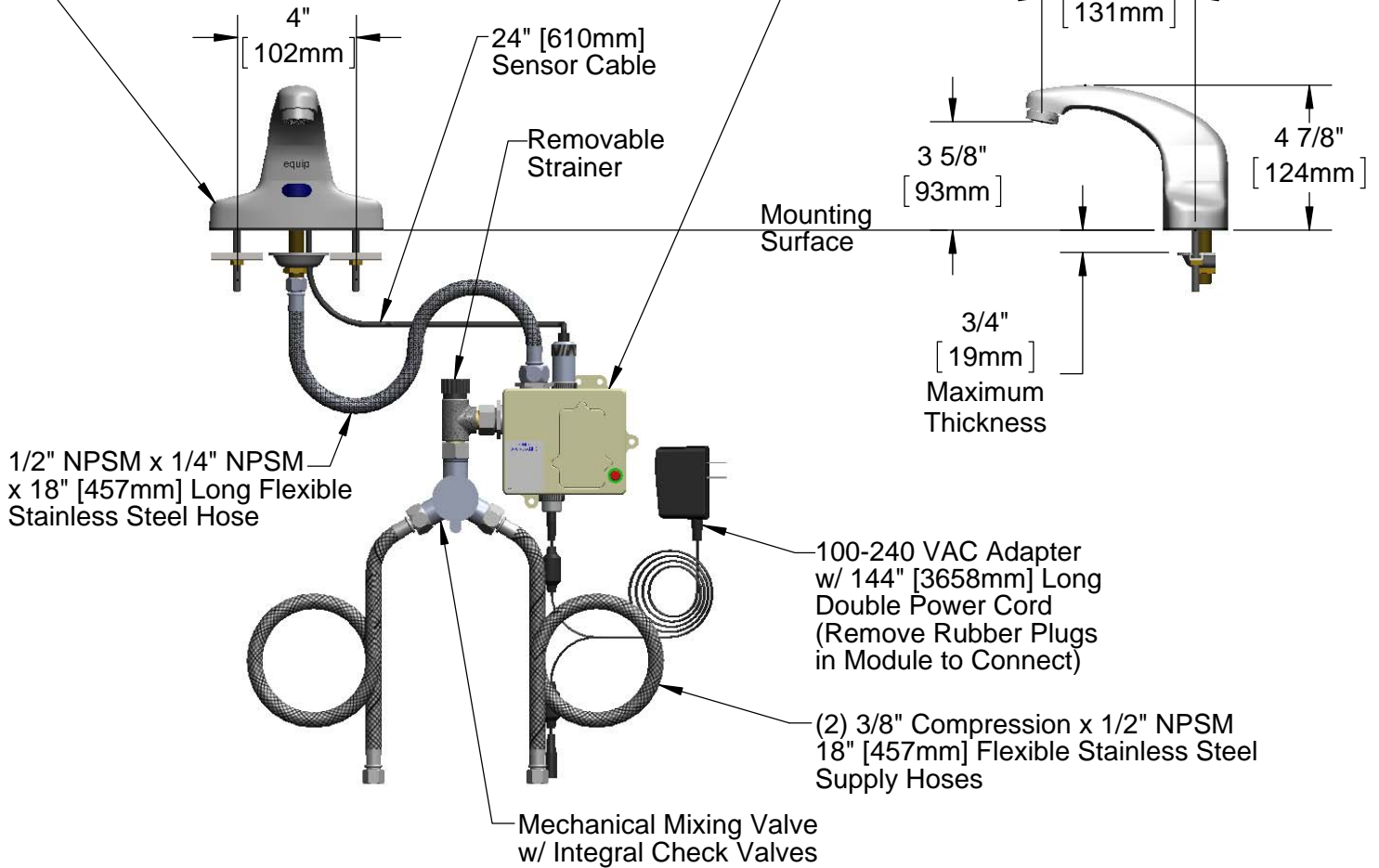

Rough-In Requirement:
(1) ϕ 1" [25mm] Center Shank Mounting Hole
(2) ϕ 1/2" [13mm] Mounting Stud Holes on 4" [102mm] Centers

Model Number 5EF-2D-DS-VF05	Date 01/07/13	Scale 1:6	Drawn DMH	Checked GEF	Approved JHB
---------------------------------------	-------------------------	---------------------	---------------------	-----------------------	------------------------



Product Specifications:

Electronic Faucet: Cast Brass Centerset Faucet w/ 4" c/c Mounting Studs, 0.5 GPM VR Spray Device, Temperature Control Mixing Valve w/ Integral Check Valves, (2) 18" Long Flex Supply Hoses & AC-DC Control Module

equip Foodservice Accessories
2 Saddleback Cove, P.O. Box 1088
Travelers Rest, South Carolina 29690
Phone: 800.891.4808 Fax: 800.868.0084

ITEM NO.	SALES NO.	DESCRIPTION
1	015425-45	Vandal Resistant Key
2	B-0199-09	Vandal Resistant 2.2 GPM Aerator w/ Key
3	5EF-0003	24" Sensor Cable
4	016297-45	Inlet Hose, Faucet, 1/2" NPSM-F x 1/4" NPSM-F
5	5EF-0001	equip Sensor Faucet - Control Module
6	5EF-0002	Equip AC Transformer, 100-240 VAC
7	5EF-0005	Supply Hose, 9/16-24 Female x 1/2" NPSM
8	5EF-0006	Mechanical Mixing Valve
9	5EF-FILTER	Replacement Filter
10	B-0199-09-N05	0.5 GPM Non-Aerator VR Spray Device

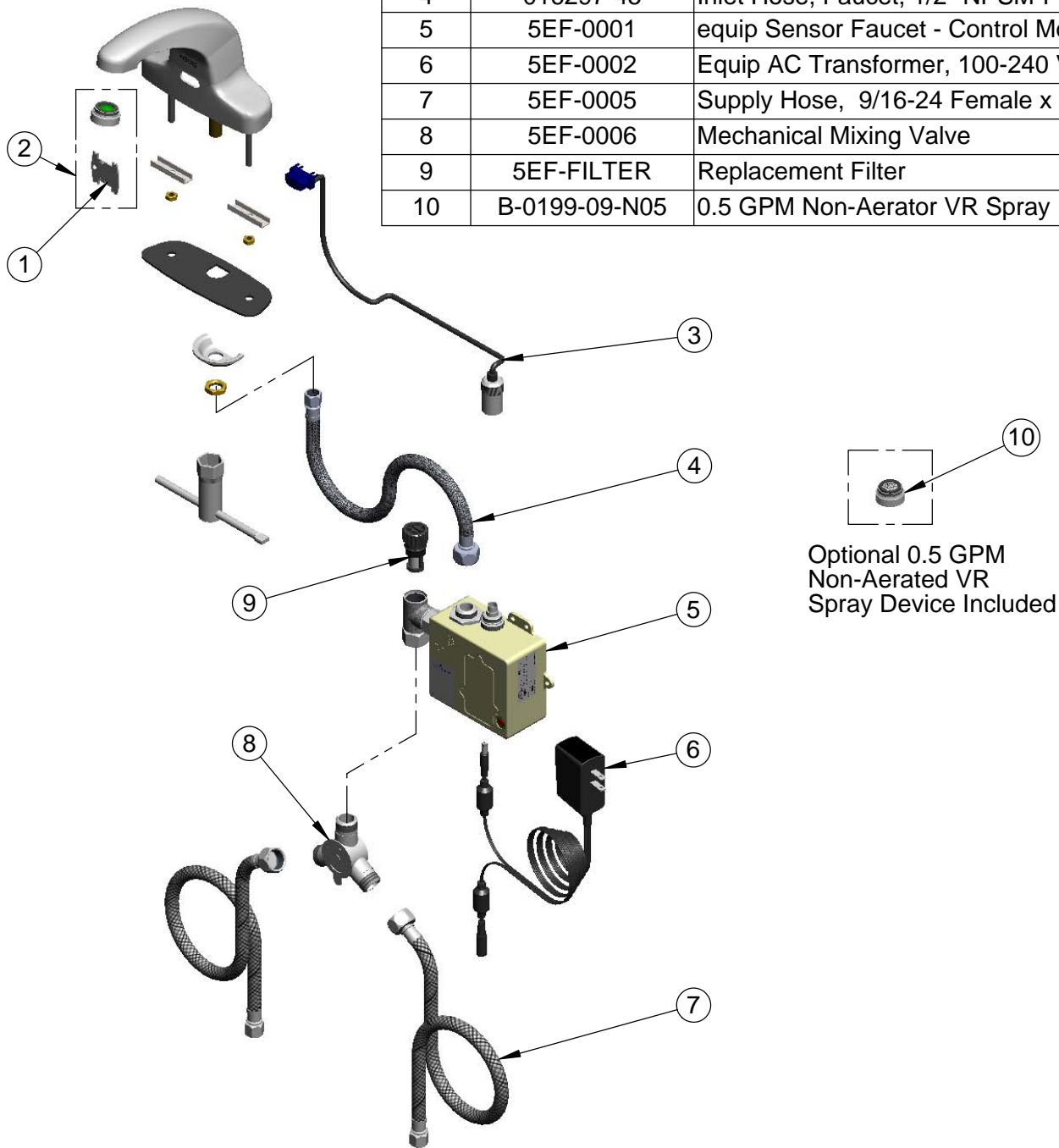

Model Number 5EF-2D-DS-VF05	Date 01/07/13	Scale NTS	Drawn DMH	Checked GEF	Approved JHB
---------------------------------------	-------------------------	---------------------	---------------------	-----------------------	------------------------



Product Specifications:

Electronic Faucet: Cast Brass Centerset Faucet w/ 4" c/c Mounting Studs, 0.5 GPM VR Spray Device, Temperature Control Mixing Valve w/ Integral Check Valves, (2) 18" Long Flex Supply Hoses & AC-DC Control Module

equip Foodservice Accessories
2 Saddleback Cove, P.O. Box 1088
Travelers Rest, South Carolina 29690
Phone: 800.891.4808 Fax: 800.868.0084