



T&S BRASS AND BRONZE WORKS, INC.

2 Saddleback Cove / P.O. Box 1088
Travelers Rest, SC 29690



REG. #A2601
ISO #9001

Model No.

B-0220-LN

Item No.

Travelers Rest, SC: 800-476-4103 • Simi Valley, CA: 800-423-0150 • Fax: 864-834-3518 • www.tsbrass.com

This Space for Architect/Engineer Approval

Job Name _____ Date _____

Model Specified _____ Quantity _____

Customer/Wholesaler _____

Contractor _____

Architect/Engineer _____



ADA Compliant

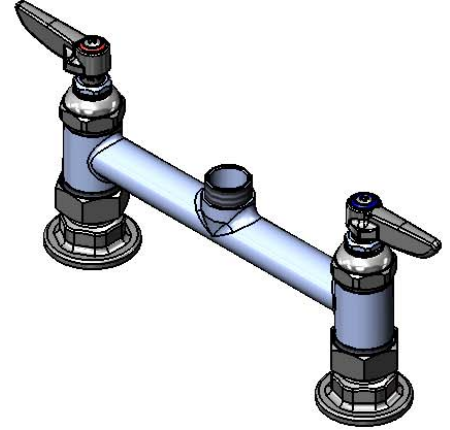

Swivel Outlet Accepts
Standard T&S Swing Nozzles

Eterna Cartridges &
Lever Handles w/
Color Coded Indexes

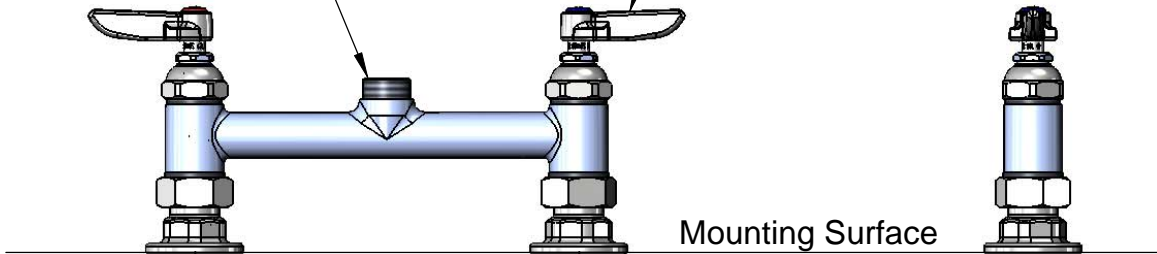

Mounting Surface

8"
[203mm]
Adjustable From
7 3/4" to 8 1/4"
[197mm to 210mm]

Ø 2" [51mm]
Flanges w/
1/2" NPT
Female Inlets

Product Specifications:
8" c/c Base Mixing Faucet (Deck Mount) w/ Eterna Cartridges
& Lever Handles (Less Nozzle)

Drawn

DHL

Checked

JRM

Approved

JHB

Scale:

1:4

Date:

03/22/11



T&S BRASS AND BRONZE WORKS, INC.

2 Saddleback Cove / P.O. Box 1088
 Travelers Rest, SC 29690



REG. #A2601
 ISO #9001

Model No.

B-0220-LN

Item No.

Travelers Rest, SC: 800-476-4103 • Simi Valley, CA: 800-423-0150 • Fax: 864-834-3518 • www.tsbrass.com

ITEM NO.	SALES NO.	DESCRIPTION
1	005959-40	Spindle Asm. Eterna "Cold"
2	005960-40	Spindle Asm, Eterna "Hot"
3	001660-45	Blue Index-CW
4	001661-45	Red Index-HW
5	000922-45	Lever Handle Screw
6	001638-45	Lever Handle
7	001019-45	Coupling Nut Washer
8	00AA	Flange Assembly

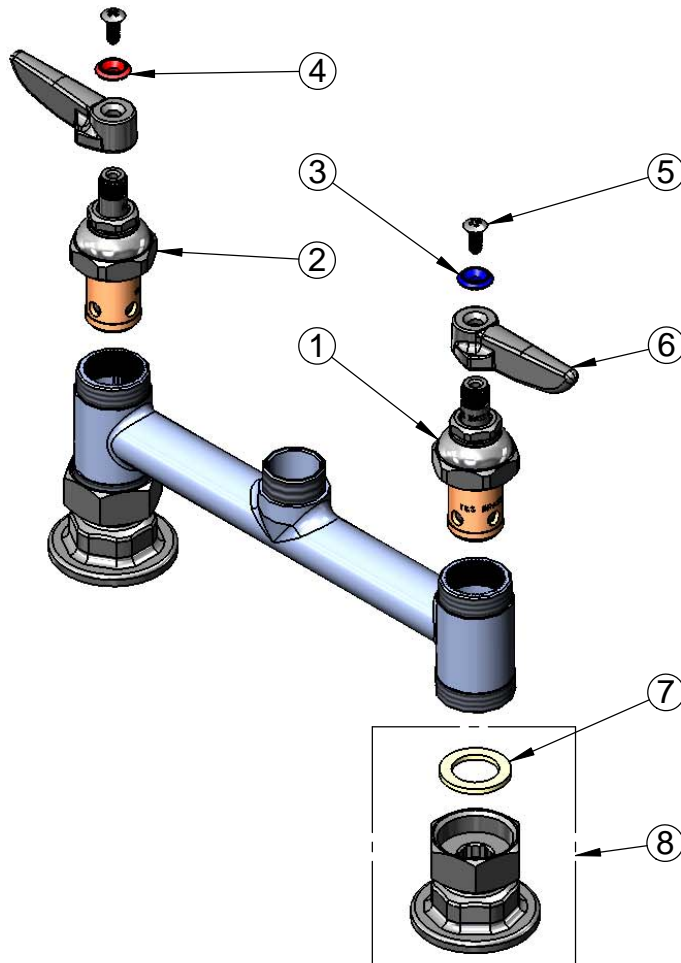

Product Specifications:
 8" c/c Base Mixing Faucet (Deck Mount) w/ Eterna Cartridges
 & Lever Handles (Less Nozzle)

Drawn DHL	Checked JRM	Approved JHB
Scale: NTS		Date: 03/22/11