



T&S BRASS AND BRONZE WORKS, INC.
 2 Saddleback Cove / P.O. Box 1088
 Travelers Rest, SC 29690



REG. #A2601
 ISO #9001

Model No.
B-0305

Item No.

Travelers Rest, SC: 800-476-4130 | San Jose, CA: 800-423-0150 | Fax: 864-834-3518 | www.tsbrass.com

This Space for Architect/Engineer Approval

Job Name _____ Date _____

Model Specified _____ Quantity _____

Customer/Wholesaler _____

Contractor _____

Architect/Engineer _____

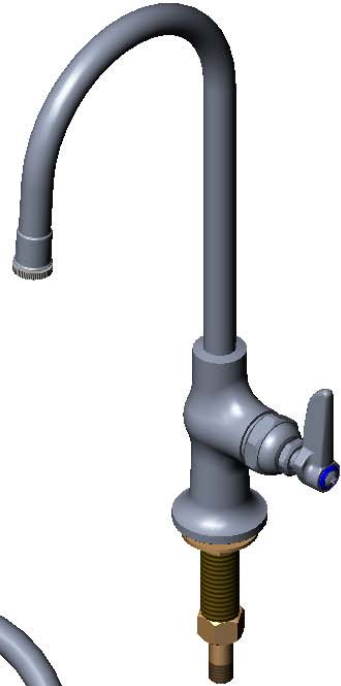

120X
 Rigid Gooseneck
 w/ B-LT Stream
 Regulator Outlet

Lever Handle
 w/ Color Coded
 Index

14 1/8"
 [359mm]

9 1/16"
 [231mm]

5 1/2"
 [140mm]

Mounting Surface

1/4" NPT
 Tailpiece, or
 remove for
 1/2" NPSM
 Male Thread
 Shank

Product Specifications:
 Single Temperature Deck Mount Faucet w/ Lever Handle,
 Eterna Cartridge & Rigid Gooseneck w/ B-LT Stream Regulator
 Outlet

Drawn KJG	Checked GEF	Approved JHB
Scale: 1:4		Date: 12/09/08



T&S BRASS AND BRONZE WORKS, INC.

2 Saddleback Cove / P.O. Box 1088
Travelers Rest, SC 29690



REG. #A2601
ISO #9001

Model No.

B-0305

Item No.

Travelers Rest, SC: 800-476-4103 Simi Valley, CA: 800-423-0150 Fax: 864-834-3518 www.tsbrass.com

ITEM	PART NO.	DESCRIPTION
1	002954-45	Shank Lock Nut
2	000999-45	Brass Lock Washer
3	005960-40	Eterna Spindle Asm, Hot
4	001638-45	Lever Handle
5	000922-45	Lever Handle Screw
6	001660-45	Blue Index-CW
7	120X	Rigid GN w/ B-LT
8	150A	Bag of (1) Nut & (1) Tailpiece

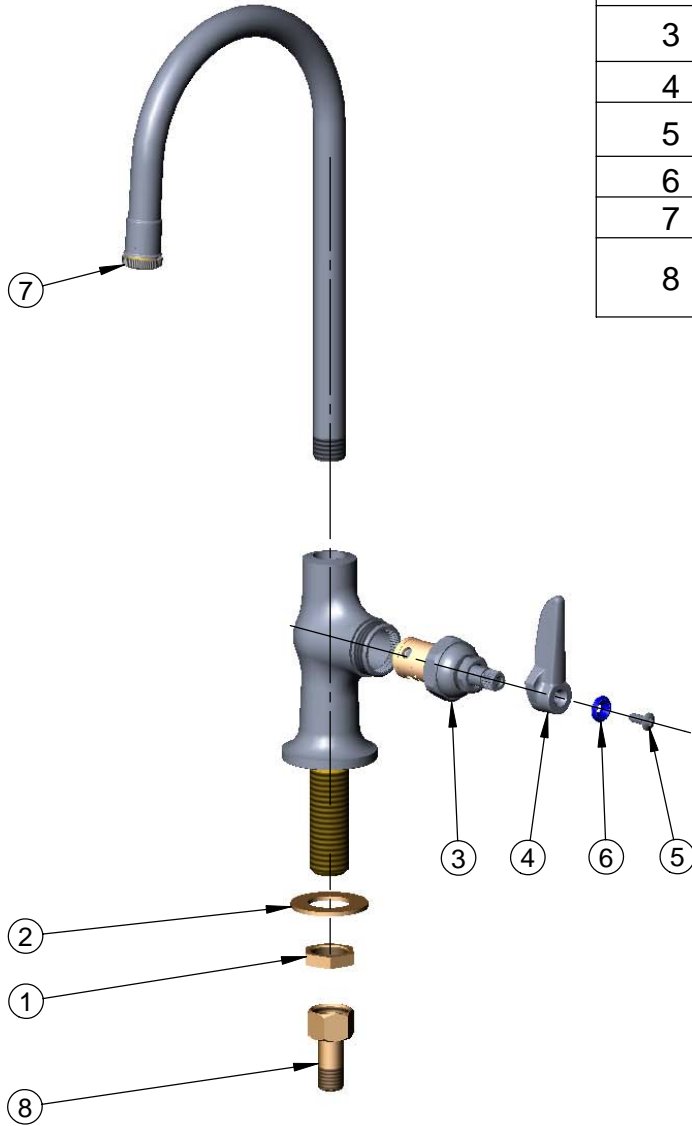

Product Specifications:

Single Temperature Deck Mount Faucet w/ Lever Handle,
Eterna Cartridge & Rigid Gooseneck w/ B-LT Stream Regulator
Outlet

Drawn
KJG

Checked
GEF

Approved
JHB

Scale:

NTS

Date:

12/09/08