



T&S BRASS AND BRONZE WORKS, INC.

2 Saddleback Cove / P.O. Box 1088
Travelers Rest, SC 29690



REG. #A2601
ISO #9001

Model No.

B-0330-LN

Item No.

Travelers Rest, SC: 800-476-4103 • Simi Valley, CA: 800-423-0150 • Fax: 864-834-3518 • www.tsbrass.com

This Space for Architect/Engineer Approval

Job Name _____ Date _____

Model Specified _____ Quantity _____

Customer/Wholesaler _____

Contractor _____

Architect/Engineer _____



ADA Compliant

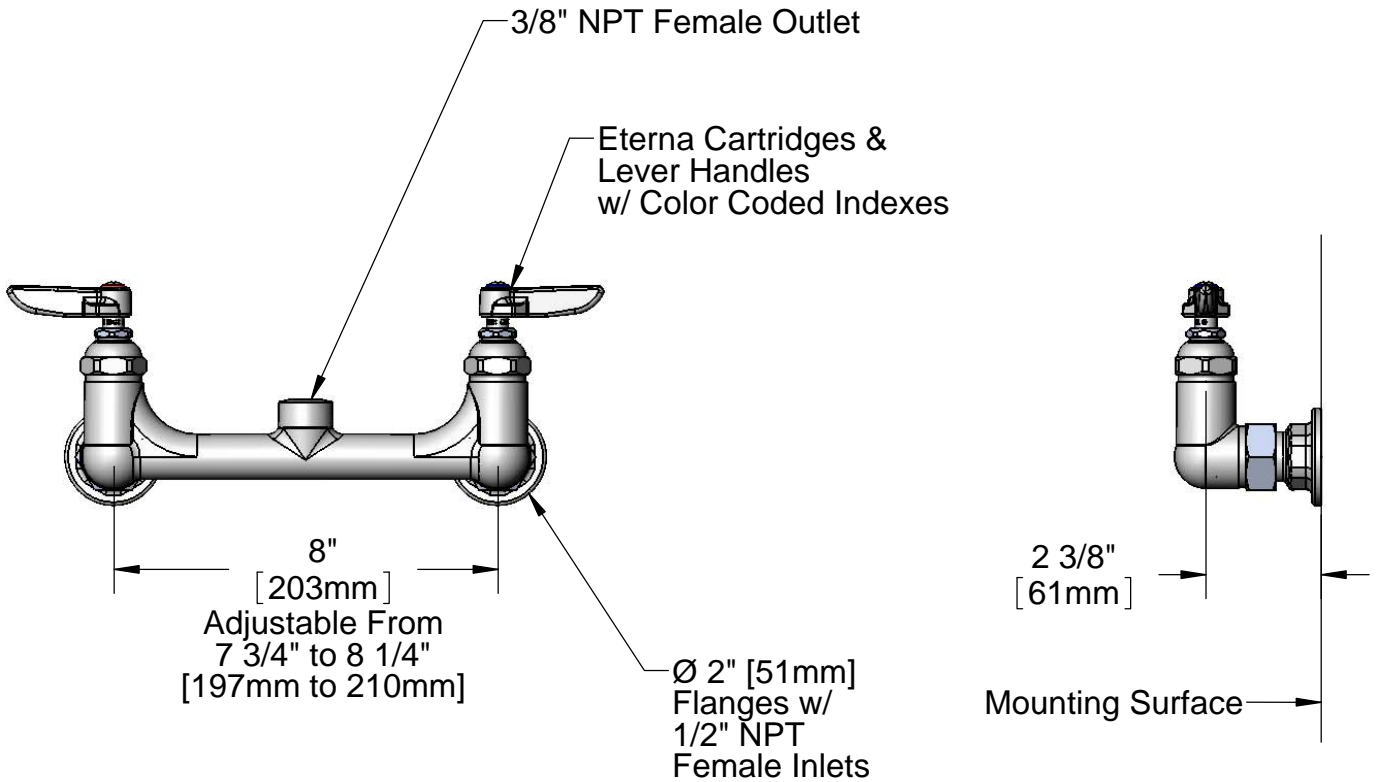
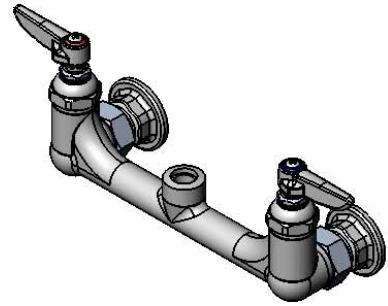

Product Specifications:
8" c/c Mixing Faucet (Wall Mount), Lever Handles & 1/2" NPT Female Inlets

Drawn

DHL

Checked

KJG

Approved

JHB

Scale:

1:4

Date:

07/29/11



T&S BRASS AND BRONZE WORKS, INC.

2 Saddleback Cove / P.O. Box 1088
 Travelers Rest, SC 29690



REG. #A2601
 ISO #9001

Model No.

B-0330-LN

Item No.

Travelers Rest, SC: 800-476-4103 • Simi Valley, CA: 800-423-0150 • Fax: 864-834-3518 • www.tsbrass.com

ITEM NO.	SALES NO.	DESCRIPTION
1	005960-40	Eterna Cartridge, RTC
2	001661-45	Red Index-HW
3	001660-45	Blue Index-CW
4	000922-45	Lever Handle Screw
5	001638-45	Lever Handle
6	00AA	Wall Coupling Flange
7	001019-45	Coupling Nut Washer
8	005959-40	Eterna Cartridge, LTC

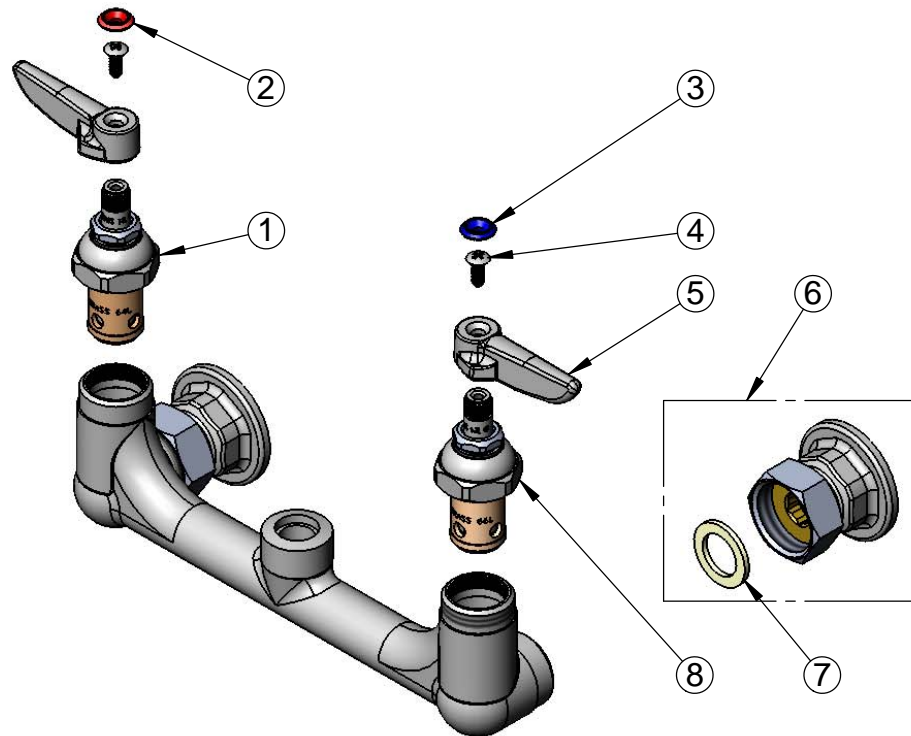

Product Specifications:
 8" c/c Mixing Faucet (Wall Mount), Lever Handles &
 1/2" NPT Female Inlets

Drawn

DHL

Checked

KJG

Approved

JHB

Scale:

NTS

Date:

07/29/11