



T&S BRASS AND BRONZE WORKS, INC.

2 Saddleback Cove / P.O. Box 1088
Travelers Rest, SC 29690



REG. #A2601
ISO #9001

Model No.

B-0662

Item No.

Travelers Rest, SC: 800-476-4103 Simi Valley, CA: 800-423-0150 Fax: 864-834-3518 www.tsbrass.com

This Space for Architect/Engineer Approval

Job Name _____ Date _____

Model Specified _____ Quantity _____

Customer/Wholesaler _____

Contractor _____

Architect/Engineer _____



ADA Compliant

1/2" NPT CW-HW
Supply Pipes
(Supplied by Others)

(4) B-0110 Pipe Supports

Integral Stop

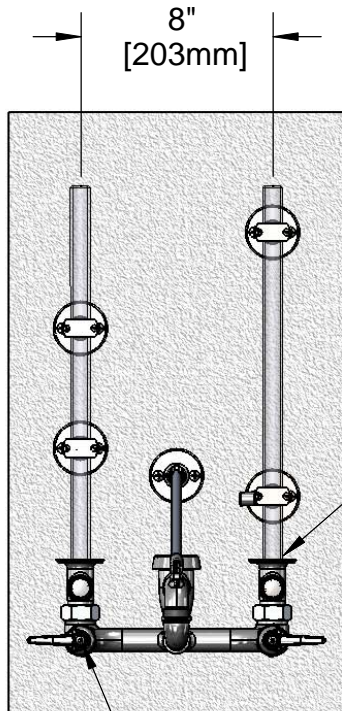
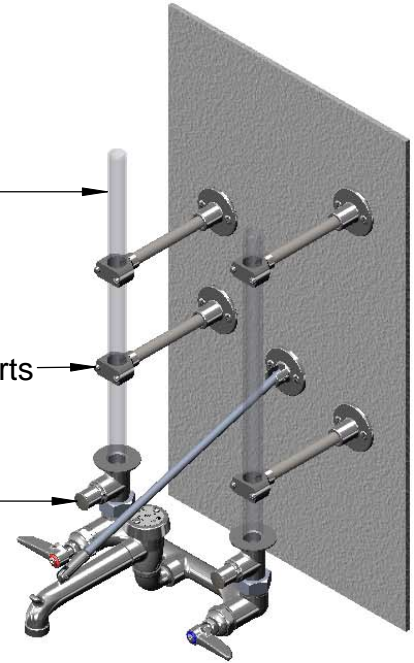

8"
[203mm]

Hot & Cold
Eterna Cartridges
w/ Spring Checks
& Lever Handles
w/ Color Coded Indexes

6"
[152mm]
Adjustable

B-0969
1/2" Vacuum Breaker

Support Rod Asm.
Furnished w/
Wall Bracket and
Mounting Screws

1/2" NPT
Female Inlet

Male Garden
Hose Outlet

8 3/4"
[222mm]

6 7/8"
[174mm]

2 1/4"
[56mm]

Product Specifications:

Service Sink Faucet, Polished Chrome Finish, Integral Stops w/
1/2" NPT Female Inlets, Vacuum Breaker & Wall Brace Assembly,
(Designed for Exposed Ceiling Supply Lines)

Drawn
DHL

Checked
GEF

Approved
JHB

Scale:

1:8

Date:

9/11/2009



T&S BRASS AND BRONZE WORKS, INC.

2 Saddleback Cove / P.O. Box 1088
Travelers Rest, SC 29690



REG. #A2601
ISO #9001

Model No.
B-0662

Item No.

Travelers Rest, SC: 800-476-4103 Simi Valley, CA: 800-423-0150 Fax: 864-834-3518 www.tsbrass.com

ITEM NO.	SALES NO.	DESCRIPTION
1	B-0969	Vacuum Breaker, 1/2"
2	001661-45	Red Index-HW
3	012443-40	Hot Eterna Spindle Assembly w/ Spring Check
4	001660-45	Blue Index-CW
5	002712-40	Hot Eterna Spindle Assembly w/ Spring Check, Handle, Index & Screw
6	000922-45	Lever Handle Screw
7	001605-45	Cap
8	001638-45	Lever Handle
9	002892-40	Spindle Asm w/ Cap
10	000763-20	Seat
11	012442-40	Cold Eterna Spindle Assembly w/ Spring Check
12	002711-40	Cold Eterna Spindle Assembly w/ Spring Check, Handle, Index & Screw
13	B-0110	Bracket Asm., 6" Wall
14	00JJ	Flange w/ Integral Stop Asm, 1/2" NPT Female Inlet
15	001019-45	Coupling Nut Washer
16	002534-25	Close Nipple, 1/2" x 1 5/32" Rough Chrome

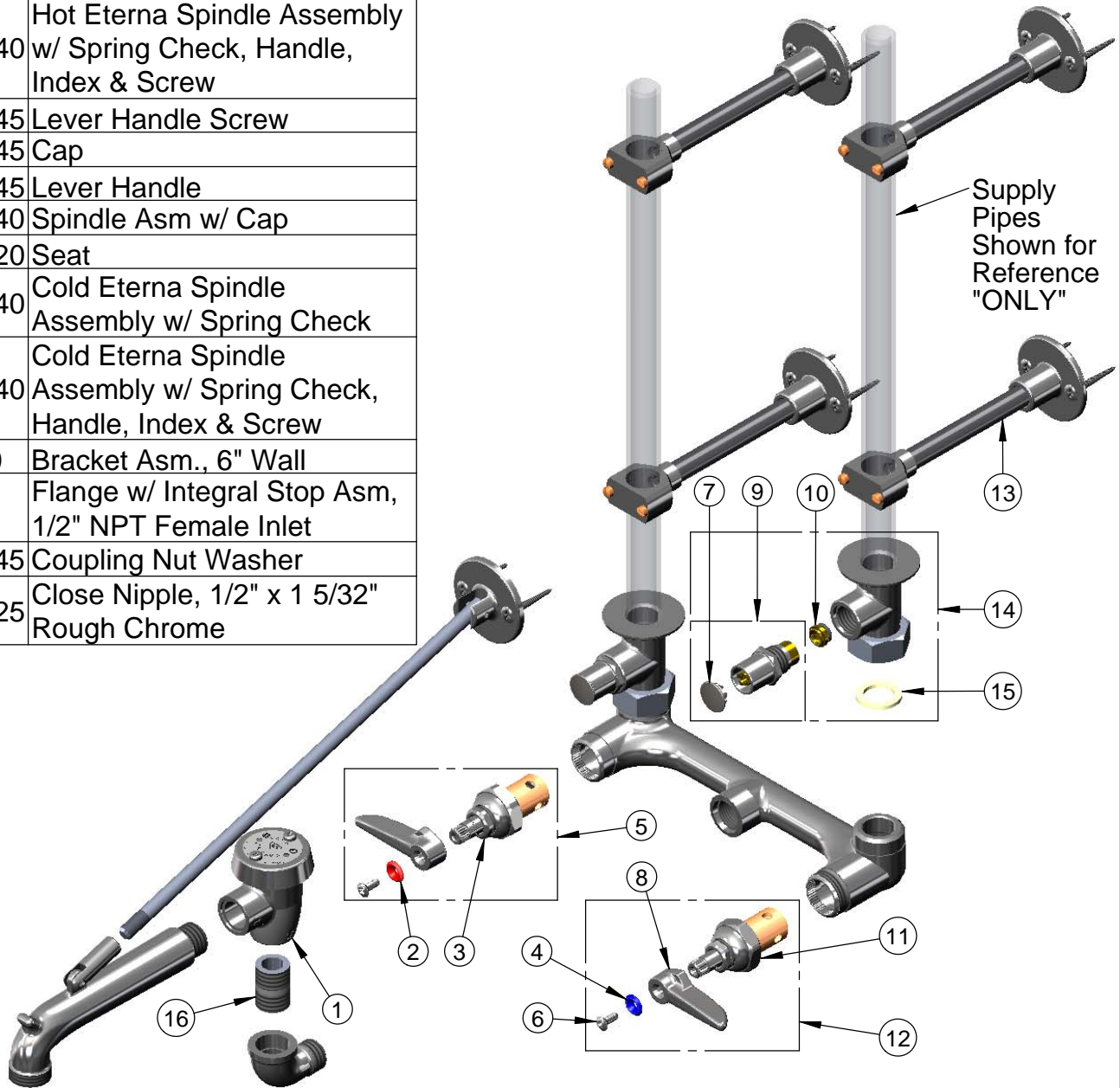

Product Specifications:

Service Sink Faucet, Polished Chrome Finish, Integral Stops w/ 1/2" NPT Female Inlets, Vacuum Breaker & Wall Brace Assembly, (Designed for Exposed Ceiling Supply Lines)

Drawn DHL	Checked GEF	Approved JHB
Scale: 1:4		Date: 9/11/2009