



T&S BRASS AND BRONZE WORKS, INC.

2 SADDLEBACK COVE / P.O. BOX 1088 / TRAVELERS REST, SC 29690

PHONE 800-476-4103 - FAX 864- 834-3518



REG. #A2601
ISO #9001

Model No.

B-2289

RELIABILITY
BUILT IN

Job Name:

Architect/Engineer Approval:

Notes:



ADA Compliant

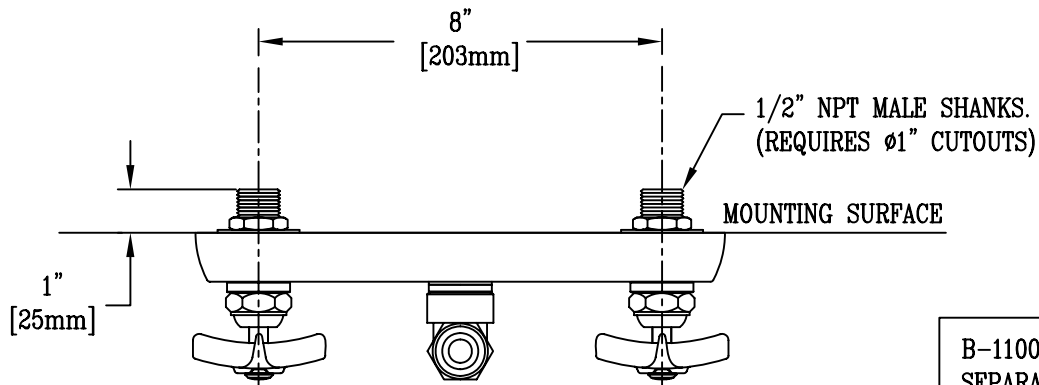

TOP VIEW

B-1100-K ELBOW KIT SOLD
SEPARATELY. CONTAINS (2)
1/2" NPT MALE 90° ELBOWS

000082-40 SWIVEL ELBOW
ACCEPTS STANDARD T&S
SWING NOZZLES

HOT & COLD INDEXED
4-ARM KITCHEN HANDLES

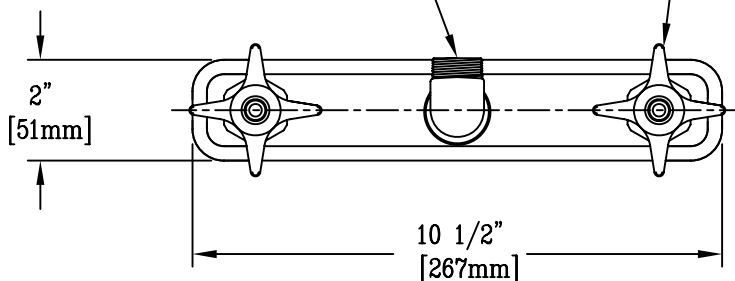

FRONT VIEW

150A Tailpiece and Nut
Furnished for 1/4" NPT
Connection

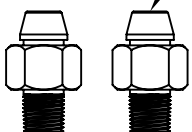

Product Description:
WALL MOUNT WORKBOARD FAUCET w/ 1/2" NPT MALE
SHANKS, 8" INLET CENTERS, LESS NOZZLE, LEVER HANDLES
& 000082-40 SWIVEL OUTLET ELBOW

Drawn:

KJG

Checked

JRM

Scale:

1 : 4

Approved

JHB

Date:

12/19/07