

INSTRUCTION MANUAL &
MSDS SHEET

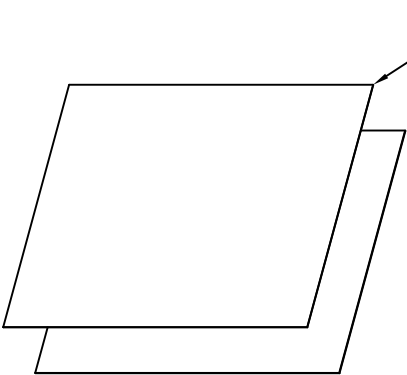

2

WALL MOUNT
BRACKET

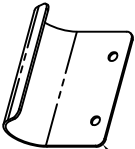

NOTES:

- 1. CERTIFIED TO ANSI STANDARD Z358.1 (LATEST REVISION).
- 2. DIMENSIONS SHOWN ARE REFERENCE.
- 3. HAWS CORPORATION MODEL NO. 7501.
- 4. EW-9082 BACTERIOSTATIC PRESERVATIVE NOT INCLUDED.

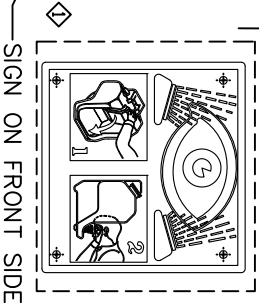
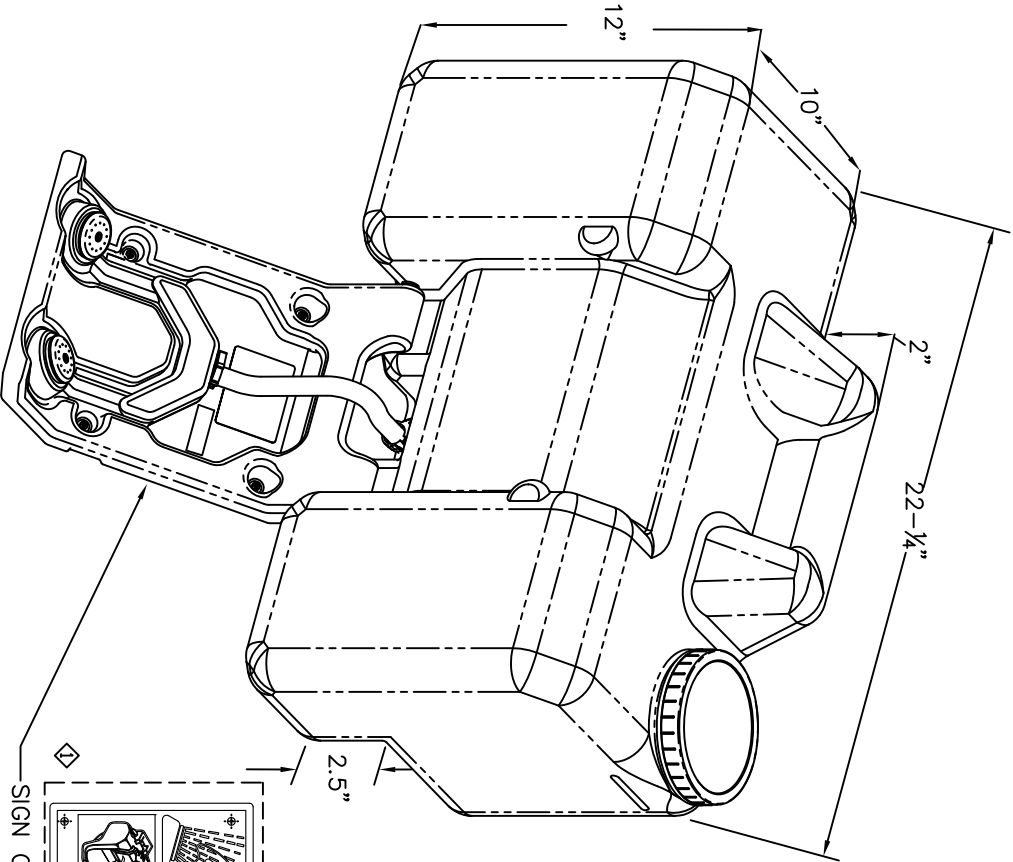

THIS DRAWING CONTAINS PROPRIETARY INFORMATION AND IS THE PROPERTY OF T&S BRASS AND BRONZE WORKS, INC. REPRODUCTION OF THIS DRAWING WITHOUT THE WRITTEN CONSENT OF T&S BRASS AND BRONZE WORKS, INC. IS PROHIBITED.		TOLERANCES UNLESS OTHERWISE SPECIFIED		MACHINE FINISH UNLESS OTHERWISE SPECIFIED	
		X.XX ±.010 CONC. .010 TIR		SURFACE FINISH:	
		X.XXX ±.005 FRAC. ±1/4		REMOVE ALL BURRS AND BREAK ANGLES #1/2° CHAMFERS 45°	
03/28/13	2	PL. PRESERVATIVE 14660-1V		DRAWN ARH 9/10/07	FINISH N/A
12/20/10	2	HWS STD PRODUCT 14-301		CHECKED GEF 12/13/07	MATERIAL N/A
12/14/07	2	INITIAL RELEASE 13483		APPROVED JHB 12/14/07	SCALE NTS
DATE	DESCRIPTION	ECO	T&S BRASS AND BRONZE WORKS, INC. P.O. BOX 1098 2 SADDLEBACK COVE TRAVELERS REST SOUTH CAROLINA 29590		DRAWING NUMBER EW-7501
REVISIONS			TITLE EYEWASH, PORTABLE (PURCHASE)		SHEET 1 OF 1