

VICTORY

3779 Champion Blvd Winston-Salem, NC 27105
856.428.4200 • 800.523.5008 • Fax: 856.428.7299
www.victoryrefrigeration.com • email: sales@victoryrefrigeration.com

PROJECT: _____
LOCATION: _____
ITEM #: _____
QUANTITY: _____

ULTRASPEC™ SERIES

BOTTOM MOUNT REFRIGERATED DISPLAY

Featuring: **SecureTemp**_{1.0}

STANDARD FEATURES

- Secure-Temp 1.0™ Technology
- Full Electronic Control
- LED Lighting
- Expansion Valve Technology
- 20 Gauge, Stainless Steel Door
- Santoprene Door Gaskets
- Stainless Steel Breaker Strips
- High Performance, Balanced, Bottom-Mounted Refrigeration
- Anti-Corrosion Coated Evaporator Coil
- Stainless Steel Exterior
- Stainless Steel Interior
- Environmentally Safe R-134a Refrigerant for Refrigerators
- Environmentally Safe R-404A Refrigerant for Freezers
- Min. 2.5" Foamed-in-Place Polyurethane Insulation
- Self-Closing Doors with 120° Hold Open Feature
- One Piece, Snap-In Magnetic Door Gasket(s)
- Heated Pressure Relief Vent
- Five (5) Heavy Duty Stainless Steel Shelves per Section
- Accommodates 18" X 26" or 12" X 20" pans
- Adjustable Leveling Legs
- Cam-Lift Hinges, Guaranteed for Life
- 10' Cord and Plug (see electrical data for details)



SECURE-TEMP 1.0™

Secure-Temp 1.0™ is the industry's first and only full service temperature monitoring solution for your kitchen. Secure-Temp 1.0™ is standard on all Victory models and is HACCP compliant and meets NAFEM's data protocol. There is NO software or monthly monitoring fees. Optional add on kits are available for additional units in your kitchen that you want to monitor.

OPTIONS AND ACCESSORIES

- Change Door Swing
- Expansion Valve Technology
- Stainless Steel Finished Back
- 4" Overall Height Casters (Set of 4)
- 220/50Hz, 220/60 Hz Voltages
- Extra Shelves

MODELS

LSR-23
LSF-23



NOTE: Not all marks refer to all models

Please refer to www.energystar.gov to view the most up-to-date product listing and performance data

3 Year Parts and Labor Warranty • 5 Year Compressor Warranty

Victory Refrigeration specification sheets are available online at www.victoryrefrigeration.com

APPROVALS:

BOTTOM MOUNT REFRIGERATED DISPLAY

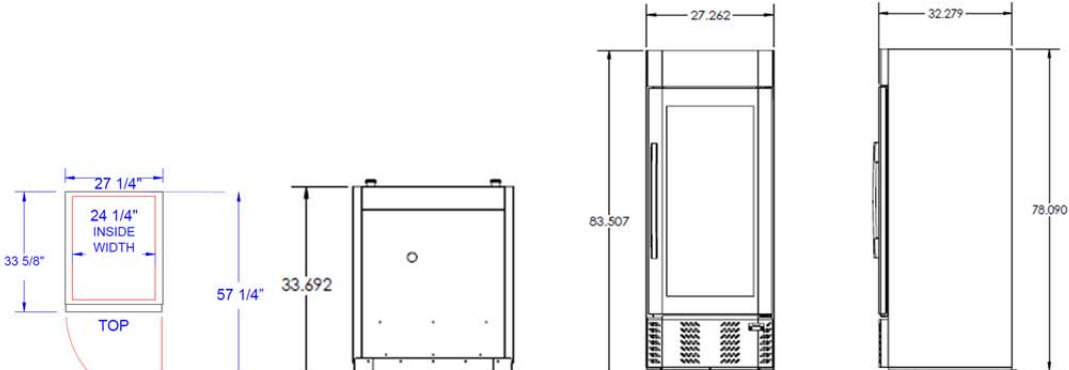

We reserve the right to change specifications and product design without notice. Such revisions do not entitle the buyer to corresponding changes, improvements, additions or replacements for previously purchased equipment. Dimensional tolerances +/- 1/4". Metric dimensions (MM)

LSR/LSF CABINET CONSTRUCTION

The cabinet front, grills and sides are constructed of polished stainless steel. The inside walls and bottom are in anodized aluminum. A minimum of 2.5" polyurethane foam insulation throughout (3.5" on the bottom) ensures energy efficiency. The front grill is snap-on / snap-off allowing easy access for cleaning the condenser.

LSR/LSF ELECTRONIC CONTROL

Electronic thermostat with manual defrost button provides a digital display of cabinet temperatures, which includes status indicators and key pad for necessary temperature adjustments

LSR/LSF REFRIGERATION SYSTEM

Self-contained bottom mount refrigeration system. Expansion valve refrigerant control on freezer provides quick temperature pull down and reduces compressor run time—meaning reduced energy consumption. Includes automatic condensate disposal. Refrigerators utilize ozone friendly R134a refrigerant. Freezers utilize ozone friendly R404A refrigerant and its defrost system is fully automatic, time-initiated and temperature terminated operation.

Freezer product temperatures from -10°F to -15°F.
Refrigerator product temperatures from 36°F to 38°F.

LSR/LSF INTERIOR STORAGE ARRANGEMENTS

Each cabinet section is provided with five (5) heavy-duty, stainless steel epoxy coated shelves. The shelves are adjustable in one inch increments.

CHARACTERISTICS	REFRIGERATOR	FREEZER
DIMENSIONAL DATA		
Width, Overall (in.)	27 1/4"	27 1/4"
Depth, Overall (inc. Handles)	33 3/4"	33 3/4"
Height Overall (in.)	78"	78"
Depth, Door(s) Open 90° (in.)	60	60
Capacity Net (cu. ft.)	23	23
No. of Full Doors	1	1
No. of Shelves	5	5
ELECTRICAL DATA		
Cabinet Voltage	115/60/1	115/60/1
Total Amperes	5.8	10.9
REFRIGERATION DATA		
Condensing Unit Size (HP)	1/3 HP	1/2 HP
Refrigerant	R-134a	R-404a
CRATED WEIGHT		
ONE SECTION	300LBS	325 LBS

NOTE: Plug style, voltage and full load amps may vary depending on certain options selected such as special voltages and compressor upgrades.

**** Remote units use R404a refrigerant standard and come with 6" legs.**