



Project:

Item Number:

Quantity:

Warmers: Model 2001 Drop-in Warmer

The Vollrath Company, L.L.C.

WARMERS: MODEL 2001 DROP-IN WARMER

MODELS: 72001 120V AC, 1000W



Model 2001 Drop-in Warmer

FEATURES

- 18-8 stainless steel 6½" (16.6 cm) deep well
- Stainless steel exterior for longer life
- Instant drop-in without permanent wiring, plumbing or installation costs
- Positioning pins hold unit in place
- Cord and plug – no wiring required
- Recommend using up to 4" (10.2 cm) deep pans – full and fractional sizes
- Meets NSF4 performance standards when using moist heat

DESCRIPTION

The Model 2001 warmer is a combination countertop/drop-in warmer. The unit has a stainless steel well and exterior, and is designed for moist or dry operation.

DIMENSIONS AND RATINGS

Receptacle

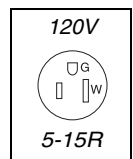

Item	Description	Cutout Dimensions IN (CM)	Dimensions (L X W X H) IN (CM)	Voltage	Watts	Amps	Plug	Case Lot
72001	Model 2001 drop-in/countertop warmer	23 ⁹ / ₁₆ x 14 ⁷ / ₁₆ (75.1 x 36.7)	24 x 15 x 8 ⁵ / ₈ (61 x 38.1 x 21.9)	120V AC	1000	8.3	5-15P	1

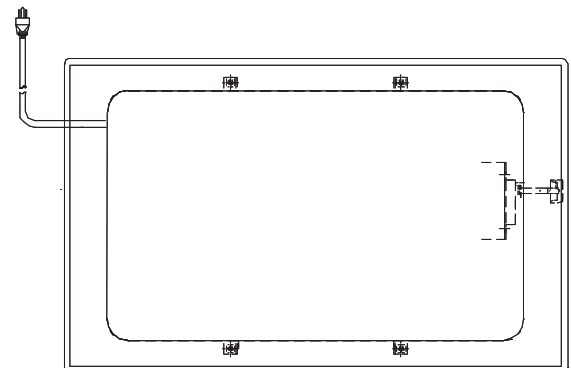
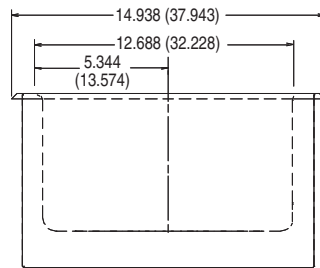
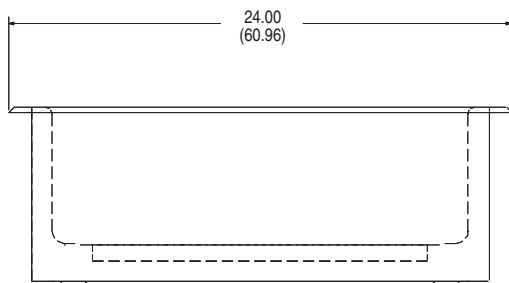

Agency Listings



Approvals

Date:



Setting the Standard™

www.vollrathco.com

The Vollrath Company, L.L.C.
1236 North 18th Street
Sheboygan, WI 53082-0611
U.S.A.
Main Tel: 800.624.2051
Service Tel: 800.628.0832
FAX: 800.752.5620

Vollrath of Canada, Co.
Tel: 800.695.8560
FAX: 800.752.5620